

NORTHERN PACIFIC RAILWAY COMPANY

AUTHORITY FOR EXPENDITURE

1923
1923
Year: 1923

Superintendent's No. 1 Dept. No. Engineering Dept. No. 13(23) A. F. E. No. 104

Seattle Div. Second District State Wash Val. Sec. No. 9

AUTHORITY IS REQUESTED FOR A NET EXPENDITURE OF \$ 335.

Accounting distribution as follows: (Distribution to be made in General Office.)

	Operating Expenses	Profit and Loss	Net Operating Expenses	Net Profit and Loss
Cost of property retired	\$	1985	\$	\$
Value of salvage		646		1339
Incidental costs			17	227
Total to Operating Expenses				\$ 17
Total to Profit and Loss Account #619 Loss on retired road & equipment				1566
To Material and Supplies				646
To Bills for Collection				
To Other Accounts				
Net charge to investment account—Additions and Betterments				1918
Total of distribution				\$ 311

DEPRECIATION
ACCOUNT 15100
ENTERED IN
LABOR 5

Budget reference: *Not in Budget* Class of Work: No. 10.
Joint facility contract reference: *Not joint*

The location is — on this company's property. To secure rights, it will be necessary

Location: **Pilchuck, Wash.**

Title: **Track decrease 923 feet
Remove tracks serving Parker Bell Lumber Co., and
abandoning bulkhead.**

Reason: **The Parker-Bell Lumber Mill has been dismantled on account of being unable to secure timber. There is no further use for tracks serving the mill and it is recommended that same be removed and metal salvaged. The removal of these tracks will make it unnecessary to maintain bulkhead or carry out work under AFE 1003-22. AFE 1003-22 should be cancelled as abandonment of bulkhead and additional embankment for toe of slope is included in this estimate.**

Original Cost Adjustment

Made in JUL 1923 19...

Check and Enter
President's Office

Work to be done by ~~company force~~ ~~contract~~ under charge of **Division Superintendent.**

Accounting to concentrate in the office of **Division Superintendent.**

Signature and Title: *[Signature]* Sup't. Date **Jan. 3rd, 19 23**

APPROVED: *[Signature]* General Superintendent. *[Signature]* Prin. Asst. Engr. or Equip. Maint. Engr. *[Signature]* Assistant General Manager.

Mech. Supt., Supt. Telgr. or Signal Engr. *[Signature]* Chief Engineer. *[Signature]* General Manager. *[Signature]* Vice President.

[Signature] General Auditor or Comptroller. *[Signature]* Charles Dring President. Date of Final Approval } **Jan 27 23** 19

COMPTROLLER'S RECORD OF NOTICE OF APPROVAL AND OF COMPLETION

Form No. 1345 issued **JAN 31 1923** Work begun 19... Work finished **April 25, 19 23**

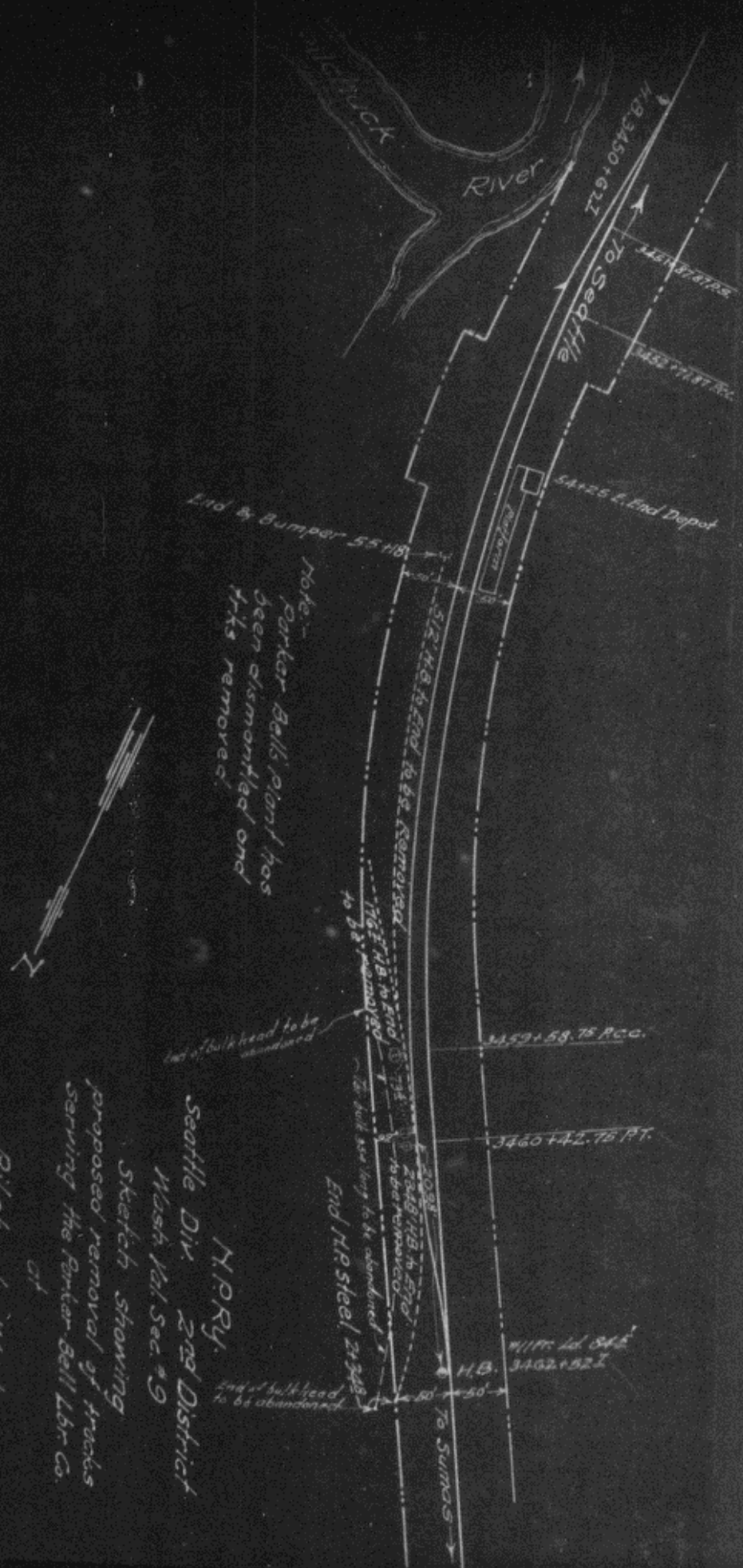

Note:
Parker-Bells plant has
been dismantled and
tks removed.

H.P.R.Y.
Seattle Div. 2nd District
Wash. Div. Sec. #9
Sketch showing
proposed removal of tracks
serving the Parker-Bell Lbr Co.
of
PILCHUCK, Wash.
Office of Dist. Engr. Seattle, W.A.
Scale 1"=100' Dec. 15, 1922