

1923

NORTHERN PACIFIC RAILWAY COMPANY
AUTHORITY FOR EXPENDITURE

Year: 1922 **1923**

Superintendent's No. **54-22**
No.

Dept. No. **3-1929**
Engineering Dept. No. **164(22)**

A. F. E. No. **91**

Seattle Div. **First** District **XXXX** State **Wash** Val. Sec. No. **#2**

AUTHORITY IS REQUESTED FOR A NET EXPENDITURE OF \$ **1629**

Accounting distribution as follows: (Distribution to be made in General Office.)

	Operating Expenses	Profit and Loss	Net Operating Expenses	Net Profit and Loss
Cost of property retired	\$	\$	\$	\$
Value of salvage				
Incidental costs			597	
Total to Operating Expenses				\$ 597
Total to Profit and Loss				
To Material and Supplies				
To Bills for Collection				
To Other Accounts				
Net charge to investment account—Additions and Betterments				1032
Total of distribution				\$ 1629

Budget reference: *not in Budget-1923*

Class of Work: No. *47*

Joint facility contract reference: *not joint*

The location is — on this company's property. To secure rights, it will be necessary

Location: **Lester, Wn., near Coal Deck**

Title and Reason: **New 24" R.C.P. Culvert**

The present wood box drain under tracks just east of coal deck at Lester which was put in in an emergency during high water is at too high an elevation to properly drain the ground north of tracks. During high water there are two to three feet of water standing in this territory which creates a bad condition for a large number of N.P.Ry. employes living in this vicinity. It is proposed to put in a 24" RCP culvert at a lower elevation which will probably drain this ground. The wood box drain to be left in its present location. To be covered by Form 134, Fall inspection 1922.

Checked and Entered
President's Office



Work to be done by ~~company~~ force under charge of **Division Superintendent**

Accounting to concentrate in the office of *Supt Seattle*

Signature and Title: *W. A. Country* Supt. Date **November 6, 1922**

APPROVED: *A. P. Book*
General Superintendent. Prin. Asst. Engr. or Engr. Maint. of W.Ry. Assistant General Manager.

W. A. Country Chief Engineer. *W. A. Country* General Manager. *J. M. Rapelys* Vice President.

W. A. Country General Auditor or Comptroller. *Charles J. Connelly* President. Date of Final Approval **11 28 22** 19

COMPTROLLER'S RECORD OF NOTICE OF APPROVAL AND OF COMPLETION

Form No. 1345 issued **JAN 30 1923** Work begun.....19..... Work finished *Jan 7, 1923*

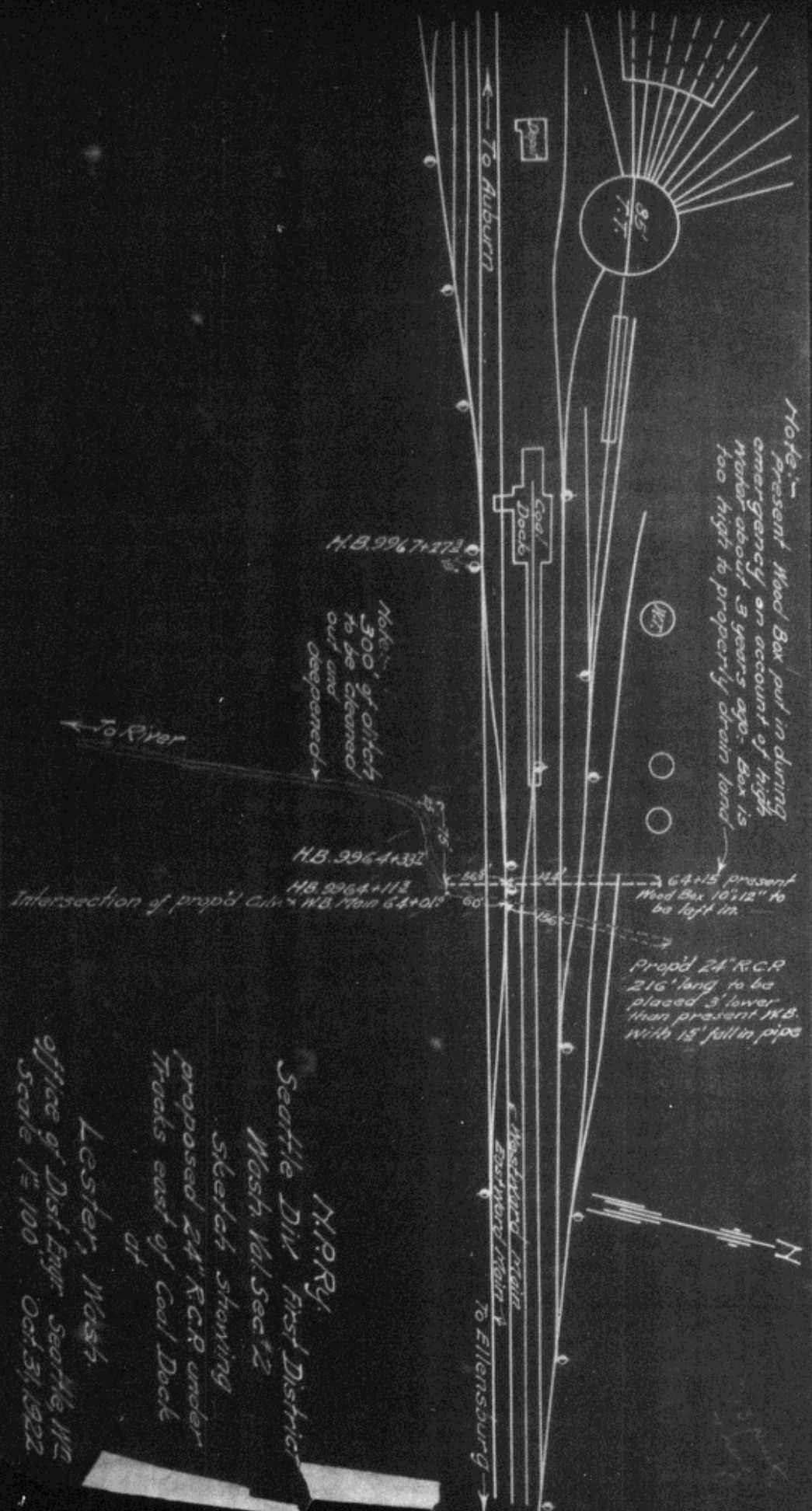

Note: Present Wood Box put in during emergency on account of high water about 3 years ago. Box is too high to properly drain land.

Note: 300' of ditch to be cleaned out and deepened.

Prop'd 24" R.C.P. 216' long to be placed 3' lower than present W.B. with 15' fall in pipe.

N.P.R.Y.
 Seattle Div First District
 Wash Val. Sec #2
 Sketch showing
 proposed 24" R.C.P. under
 tracks east of Coal Dock
 at
 Lester, Wash.
 office of Dist Engr. Seattle, WA
 Scale 1" = 100' Oct. 31, 1922