

1922

# NORTHERN PACIFIC RAILWAY COMPANY 1922

AUTHORITY FOR EXPENDITURE

Year: 1922

DEPRECIATION DOCUMENT 15100 EXHIBIT E

President's No. 2  
No.

Dept. No. Engineering Dept. No. 3

A. F. E. No. 85

St. Paul Div. Main Line District State Minn. Val. Sec. No. 6

AUTHORITY IS REQUESTED FOR A NET EXPENDITURE OF \$ 42.

Accounting distribution as follows: (Distribution to be made in General Office.)

	Operating Expenses	Profit and Loss	Net Operating Expenses	Net Profit and Loss
Cost of property retired	\$ 50	\$ 74	\$ 50	\$ 32
Value of salvage	50	42	50	
Incidental costs				
Total to Operating Expenses				\$ 32
Total to Profit and Loss				\$ 42
To Material and Supplies				\$ 42
To Bills for Collection (Berglund Lumber Company)				\$ 322
To Other Accounts				
Net charge to investment account—Additions and Betterments				74
Total of distribution				\$ 322

Budget reference: Not in Budget

Joint facility contract reference: Not Joint Account

The location is ----- on this company's property. To secure rights, it will be necessary

Location: St. Paul, Minnesota.

Title: Remove portion of Berglund Lumber Company track and install bumping posts. Made in MAR. 1922

Reason: The Berglund Lumber Company recently constructed an additional building adjacent to a Northern Pacific track serving their plant. Their plans contemplated the construction of an overhead passageway to a building on the opposite side of the track. The Railway Company was not advised of the plan until the building had been constructed. The passageway cannot now be constructed over the track and provide sufficient clearance to comply with the Minnesota State clearance law without remodeling the building which would involve an expenditure that is prohibitive.

It is therefore proposed to remove 75 feet of track at a point where the passageway will be constructed and install bumping posts at the ends of the two stub tracks created by the removal.

The expense involved in carrying out the work will be borne by the Berglund Lumber Company. A contract has been executed by the applicant providing that in the event that it should become necessary (over)

Work to be done by company force under charge of Superintendent

Accounting to concentrate in the office of Superintendent

Signature and Title: *[Signature]* Date January 13th 1921

APPROVED: <i>[Signature]</i> General Superintendent.	<i>[Signature]</i> Engr. Maint. of Way.	<i>[Signature]</i> Assistant General Manager.
Mech. Supt. Telg. or Signal Engr.	<i>[Signature]</i> Chief Engineer.	<i>[Signature]</i> General Manager.
<i>[Signature]</i> General Auditor or Comptroller.	<i>[Signature]</i> President.	<i>[Signature]</i> Vice President.

Checked and Entered President's Office  
BENTON

### COMPTROLLER'S RECORD OF NOTICE OF APPROVAL AND OF COMPLETION

Form No. 1345 issued FEB 2 1922 Work begun 1922 Work finished Oct. 24, 1922

to restore the track to its original position, the Berglund Lumber Company will reconstruct the passageway to provide the clearance required to comply with the law.

The proposal change has the approval of the Traffic Department and it is recommended the work be done at once.

T. J. Lowry,  
Superintendent.

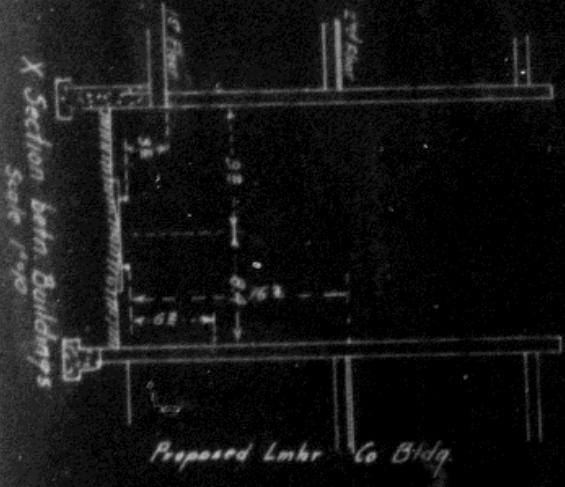

76 St Paul

76+03 H.B.

Arcade Str.



60



Prop. Etn B. Post Co 75+72 1/2



St. Paul  
Prop. Trk. Remov.  
Berglund Lbr Co

Office Dist  
From  
Remov  
Ordnance  
Valuation See

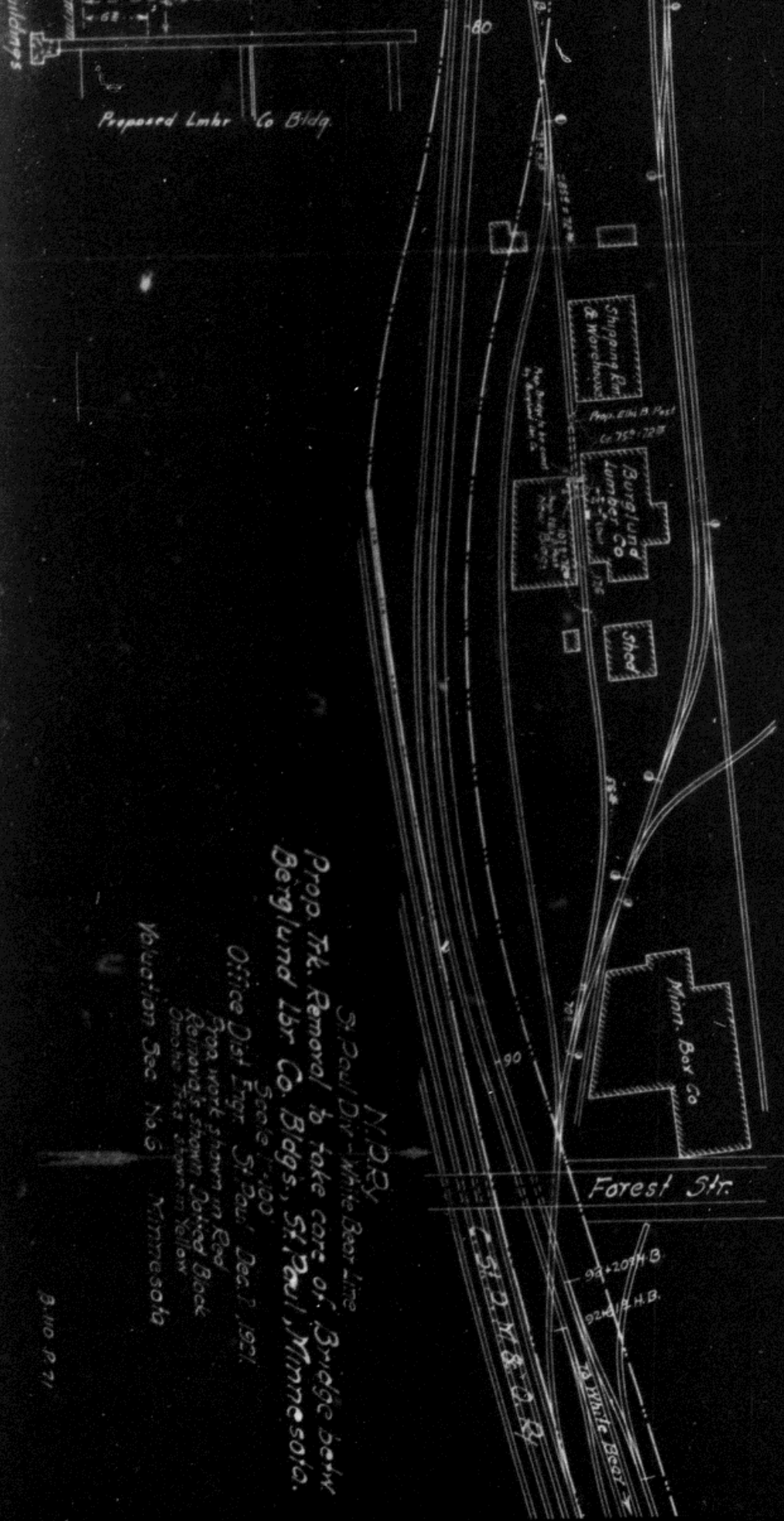

Prop. Trk. Removal to take care of Bridge betw  
 Berglund Lbr Co. Bldgs., St. Paul, Minnesota.

Office Dist Engr. St. Paul, Dec. 2, 1921.  
 For work shown in Red  
 Removals shown in Black  
 Other Trks shown in Yellow  
 Valuation Sec No 5  
 Minnesota

B. 110 P. 71