

1923

COMPTROLLER'S COPY

NORTHERN PACIFIC RAILWAY COMPANY

AUTHORITY FOR EXPENDITURE

Year: 1923

1923

Superintendent's No. 4
No.

Dept. No. Engineering Dept. No. 7

A. F. E. No. 68

St. Paul Minn. Main Line State Minn. Val. No. 11 9

AUTHORITY IS REQUESTED FOR A NET EXPENDITURE OF \$ 173.00

Accounting distribution as follows: (Distribution to be made in General Office.)

	Operating Expenses	Profit and Loss	Net Operating Expenses	Net Profit and Loss
Cost of property retired	\$	\$	\$	\$
Value of salvage				
Incidental costs				
Total to Operating Expenses				
Total to Profit and Loss				
To Material and Supplies				
To Bills for Collection				
To Other Accounts				
Net charge to investment account—Additions and Betterments				173
Total of distribution				\$173



Budget reference: ~~Not~~ In Budget Item 443 22 Class of Work: No. 171

Joint facility contract reference: Not Joint.

The location is - - - on this company's property. To secure rights, it will be necessary Nothing.

Location: Randall, Minn.

Title and Reason: Proposed Electric Lights in Depot.

On August 31st, 1922, the Village of Randall voted by a very large majority to issue bonds to build an electric transmission line from Little Falls. Arrangements were immediately made to let the contracts and the work was completed December 23, 1922, and that every business house in the village, as well as practically all of the private residences will be wired, and the citizens are very anxious to have the Railroad Company install electric lights in the depot.

We have 24 hour telegraph service at this station with six passenger trains passing through this village each night, two of them stopping practically every night; and it is felt that we should grant the wishes of the citizens by installing lights in the depot and on the platform, which not only improves the appearances about the station when viewed from passing trains, but enables us to keep the inside of our station much cleaner.

It is recommended that the work be done at an early date.

Work to be done by ~~company force~~ under charge of Superintendent.

Accounting to concentrate in the office of Superintendent.

Signature and Title: *[Signature]* Superintendent Date January 11, 1923

APPROVED: *[Signature]* General Superintendent. *[Signature]* Engr. Maint. of Way. *[Signature]* Assistant General Manager.

Mech. Supt., Supt. Trench or Signal Engr. *[Signature]* Chief Engineer. *[Signature]* General Manager. *[Signature]* Vice President.

[Signature] General Auditor or Comptroller. *[Signature]* President. Date of Final Approval } 12 3 19

COMPTROLLER'S RECORD OF NOTICE OF APPROVAL AND OF COMPLETION

Form No. 1345 issued JAN 20 1923 Work begun 19 Work finished Apr 17, 1923

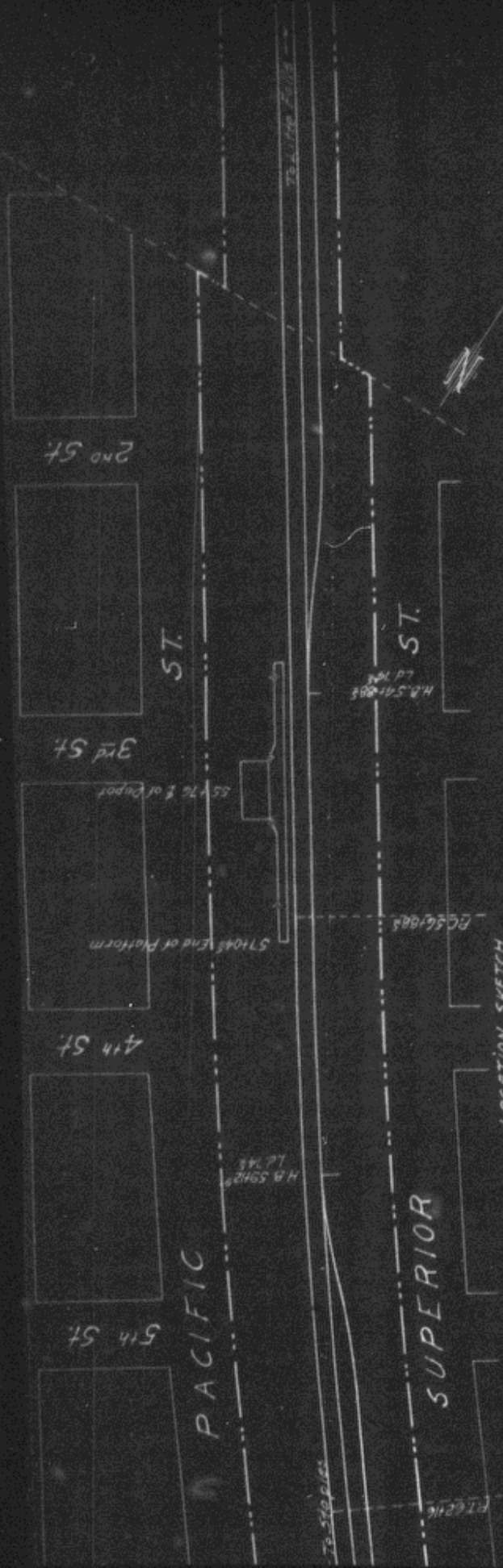

LOCATION SKETCH
Scale 1" = 100'

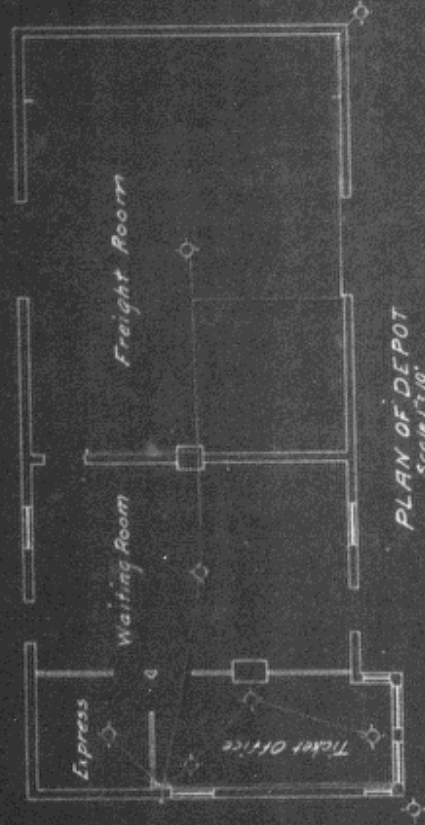

PLAN OF DEPOT
Scale 1" = 10'

N.P.Ry. }
St. Paul Div. } Main Line
Sketch Showing
Propd. Installation of Electric Lights
in Depot at Randall, Minn.
Office of Dist. Engr. St. Paul, Minn. Dec. 21/1922.
Scales as shown
Valuation Section No. 9 of Minnesota
Propd New Work shown Red.
Lights shown thus ↘