

Form 1181 1922

NORTHERN PACIFIC RAILWAY COMPANY

AUTHORITY FOR EXPENDITURE

Year: 1922

Superintendent's No. 163
No.

Dept. No. Engineering Dept. No. 183(21)

A. F. E. No. 64

Tacoma Div. Grays Harbor District State Wash Val. Sec. No. 28
Line Branch

AUTHORITY IS REQUESTED FOR A NET EXPENDITURE OF \$4103.

Accounting distribution as follows: (Distribution to be made in General Office.)

	Operating Expenses	Profit and Loss	Net Operating Expenses	Net Profit and Loss
Cost of property retired	\$ 322		\$ 322	
Value of salvage				
Incidental costs				
Total Operating Expenses				\$ 322
Total to Profit and Loss				
To Material and Supplies				
To Bills for Collection				
To Other Accounts				
Net charge to investment account—Additions and Betterments				3781
Total of distribution				\$ 4103



CORPORATE
Class of Work: Original Cost Adjustment
Made in JUN 1921

Budget reference: *Not in Budget*

Joint facility contract reference: *Not joint*

The location is _____ on this company's property. To secure rights, it will be necessary to _____

Location: Tulips (near) Washington

Title and: Bridge constructed west of Bridge #85 account washout.

Reason: On Peninsular extension of Grays Harbor Line between Hoquiam and Moclips frequent washouts occur just west of Tulips station due to backing up and overflowing of Humptulips River. Track at this point is below high water line and washouts are caused by water breaking over embankment and undermining the opposite side, also partly caused by heavy floatage of logs in Humptulips River which results in damming current to some extent.

Track was washed out in this locality in November 1921 highwater and twelve span pile bridge constructed to carry track over washout and considered best to leave this structure in permanently in order to provide additional opening for water. This RFA submitted to cover work completed ~~in~~ December 6th 1921.

Work completed Dec. 6 1921

Checked and Entered
President's Office

Work ~~to be done by~~ company force ~~contract~~ under charge of

Superintendent

Accounting to concentrate in the office of

Superintendent



Signature and Title:

W. Wallace
Superintendent

Date December 16, 19 21

APPROVED:

A. C. Bowen
General Superintendent.

A. C. Booth
Engr. of ~~1921~~ 1921

Assistant General Manager.

Mech. Supt. or Supt. Teigh.

[Signature]
Chief Engineer.

[Signature]
General Manager.

[Signature]
Vice President.

[Signature]
Comptroller.

[Signature]
President.

Date of Final Approval } JAN 25 1922 } 19

COMPTROLLER'S RECORD OF NOTICE OF APPROVAL AND OF COMPLETION

Form No. 1345 issued JAN 30 1922 19 _____ Work begun _____ 19 _____ Work finished Feb 28 19 22

Standard Spike beam
 2091172
 2091160E
 2091140E
 2091131E
 2091117E
 2091102E
 2090187E
 2090172E
 2090158E
 2090145E
 2090129E
 2090115E
 2090100 = 666+570
 Tip Tie

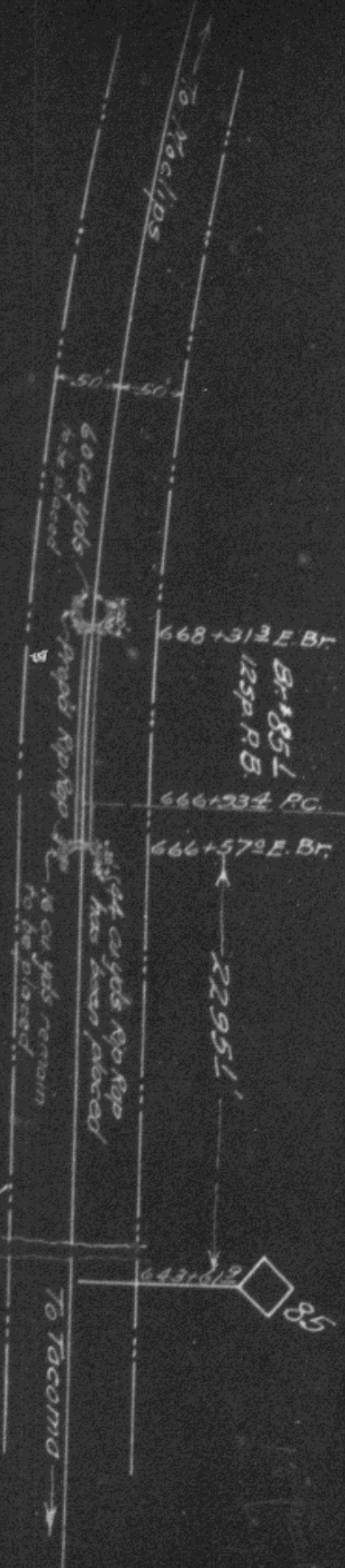

T.P.Ry
 Tacoma Div. Grays Harbor Line
 Wash Vol Sec #28
 sketch showing bridge #85-
 constructed account of Washout
 of
 Tulips, Wash
 office of Dist. Engr. Tacoma, W2
 Scale 1" = 100' Dec 19, 1921