

1922

NORTHERN PACIFIC RAILWAY COMPANY

AUTHORITY FOR EXPENDITURE

Year: 1922

Superintendent's No. **01**

Dept. No. **Engineering Dept. No. 120(21)**

A. F. E. No. **58**

Puget Sound Div. District State **Wash.** Val. Sec. No. **4**

AUTHORITY IS REQUESTED FOR A NET EXPENDITURE OF \$ 1,121.00
AUTHORITY IS REQUESTED FOR A NET EXPENDITURE OF \$ 1,121.00
Accounting distribution as follows: (Distribution to be made in Fiscal Office.)

Cost of property retired	\$	
Value of salvage	\$	
Incidental costs	\$	
Total to Operating Expenses	\$	
Total to Profit and Loss	\$	
To Material and Supplies	\$	
To Bills for Collection	\$	211
To Other Accounts	\$	
Net charge to investment account—Additions and Betterments	\$	
Total of distribution	\$	211

Budget reference: *Not in Budget* Class of Work: No. **101**

Joint facility contract reference: *Not joint*

The location is *not* on this company's property. To secure rights, it will be necessary

Location: **Tacoma, Wa.**

Title **Extend track for American Wood Pipe Co.**
and
Reason:

The American Wood Pipe Company, an established industry at Tacoma, had quite a number of cars of material on hand which they wanted unloaded, as material was required, and also to save paying demurrage. They requested an extension of the present spur 120 feet, and the same was authorized immediately by Assistant to the President Mr. Geo. T. Reid, on November 6th, 1921. Spur track agreement form 802 signed under date of November 6th, attached hereto. Work completed November 7th, 1921.

Checked and Entered
President's Office



Work ~~authorized~~ **supervised by** company force under charge of **Div. Supt.**
contract

Accounting to concentrate in the office of **Supt. at Seattle.**

Signature and Title: *[Signature]* Date **Dec. 17** 19 **21.**

APPROVED: <i>[Signature]</i> General Superintendent.	<i>[Signature]</i> Prin. Asst. Engr. or Equip. Master	<i>[Signature]</i> Assistant General Manager.
<i>[Signature]</i> Mech. Supt., Supt. Telegraph or Signal Engr.	<i>[Signature]</i> Chief Engineer.	<i>[Signature]</i> General Manager.
<i>[Signature]</i> Comptroller.	<i>[Signature]</i> President.	<i>[Signature]</i> Vice President.
Date of Final Approval		Dec 25 1922

COMPTROLLER'S RECORD OF NOTICE OF APPROVAL AND OF COMPLETION

Form No. 1345 issued **JAN 30 1922** Work began **19** Work finished **11-7**

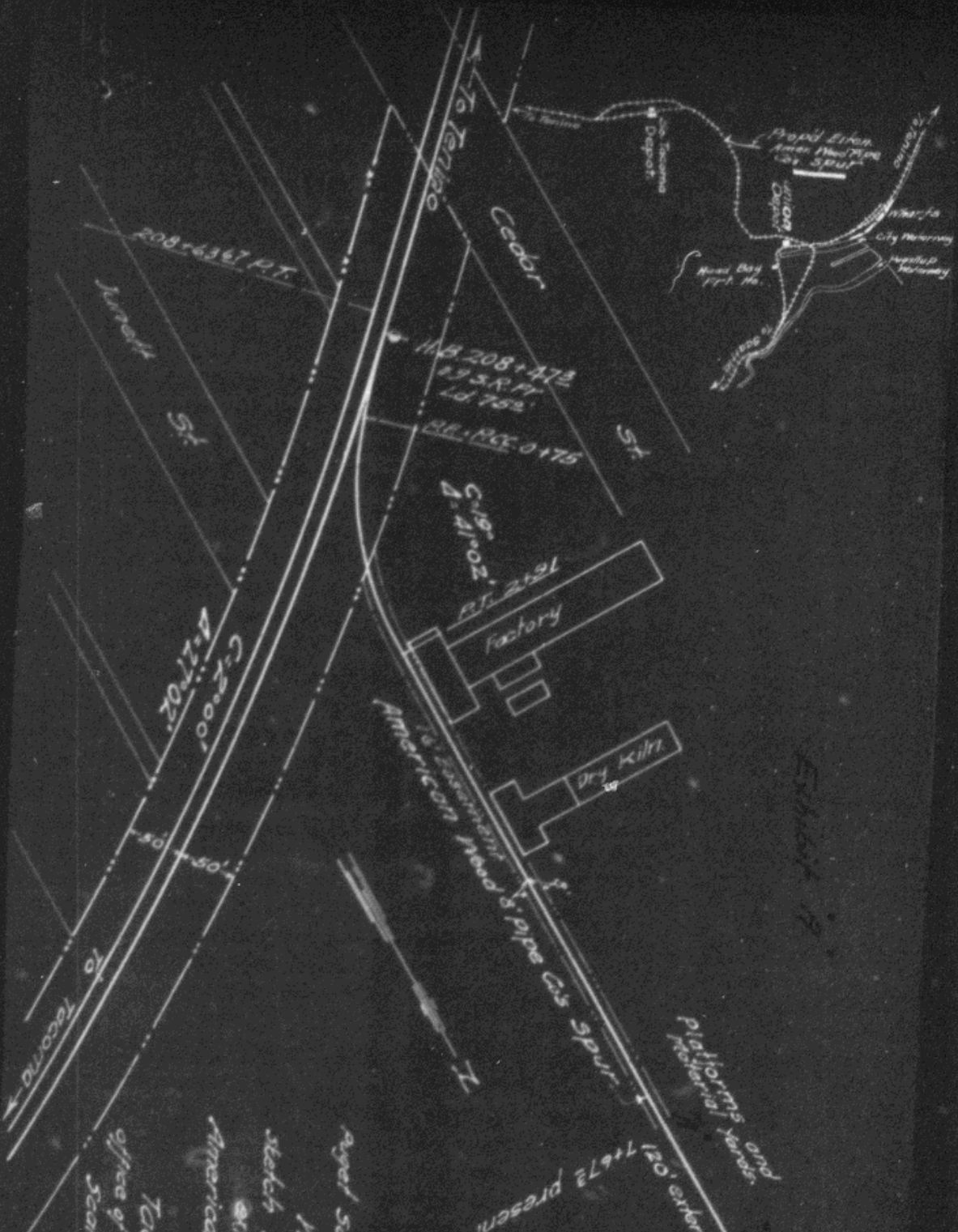

T.P.Ry.
 ayer Sound Div. Prairie Line
 Wash. Vol. Sec. 44
 sketch showing proposed
 extension to
 American Wood pipe Gas spur
 of
 Tacoma, Wash.
 office of Dist. Engr. Tacoma W2
 Scale 1" = 100' Dec 2, 1921

6+87 3/4 propd end
 7+67 3/4 present end
 120' extn
 platforms and
 tracks

Sheet 2