

Form 1343 1922

NORTHERN PACIFIC RAILWAY COMPANY

AUTHORITY FOR EXPENDITURE

Year: 1922

Superintendent's No. 80
No.

Dept. No. Engineering Dept. No. 15(22)

A. F. E. No. 33

• IDAHO Div.

Second District State WASH
Branch

Val. Sec. No. 1-8

AUTHORITY IS REQUESTED FOR A NET EXPENDITURE OF \$ 104

Accounting distribution as follows: (Distribution to be made in General Office.)

	Operating Expenses	Profit and Loss	Net Operating Expenses	Net Profit and Loss
Cost of property retired	\$	\$	\$	\$
Value of salvage				
Incidental costs				
Total to Operating Expenses				
Total to Profit and Loss				\$
To Material and Supplies				
To Bills for Collection				
To Other Accounts				
Net charge to investment account - Additions and Betterments				
Total of distribution				104 \$ 104



Budget reference: *Not in Budget*
Joint facility contract reference: *Not joint*

Class of Work: No. 217

The location is _____ on this company's property. To secure rights, it will be necessary

Location: **PARKWATER, WASHINGTON.**

Title **Installing eight steel lockers in store room.**
and

Reason: **There are no locker facilities at the Parkwater store and the laborers employed there consequently are not provided with proper facilities for their clothing. As a result, they are compelled to hang their clothing, caps, old shoes etc., around about the store room where ever they find a nail or a peg for the purpose. There have been cases where greasy over-clothes and gloves have been stuffed away on shelves with material, this creating a fire hazard.**

Checked and 3 minutes
President's office

• Work to be done by company force ^{at} _{cost of} _____ under charge of

SUPERINTENDENT

Accounting to concentrate in the office of _____

SUPERINTENDENT

Signature and Title: *[Signature]*
SUPERINTENDENT

Date **Dec. 23rd** 19 **21n**

APPROVED <i>[Signature]</i> General Superintendent.	<i>[Signature]</i> Engr. of Bridge & Work 12/31/21	<i>[Signature]</i> Assistant General Manager.
Mech. Supt. or Supt. Telgh. <i>[Signature]</i> Chief Engineer.	<i>[Signature]</i> General Manager.	<i>[Signature]</i> Vice President.
<i>[Signature]</i> Comptroller.	<i>[Signature]</i> President.	Date of Final Approval } JAN 23 1922 19



COMPTROLLER'S RECORD OF NOTICE OF APPROVAL AND OF COMPLETION

Form No. 1345 issued **JAN 24 1922** Work begun _____ 19 _____ Work finished **Mar 31 1922**

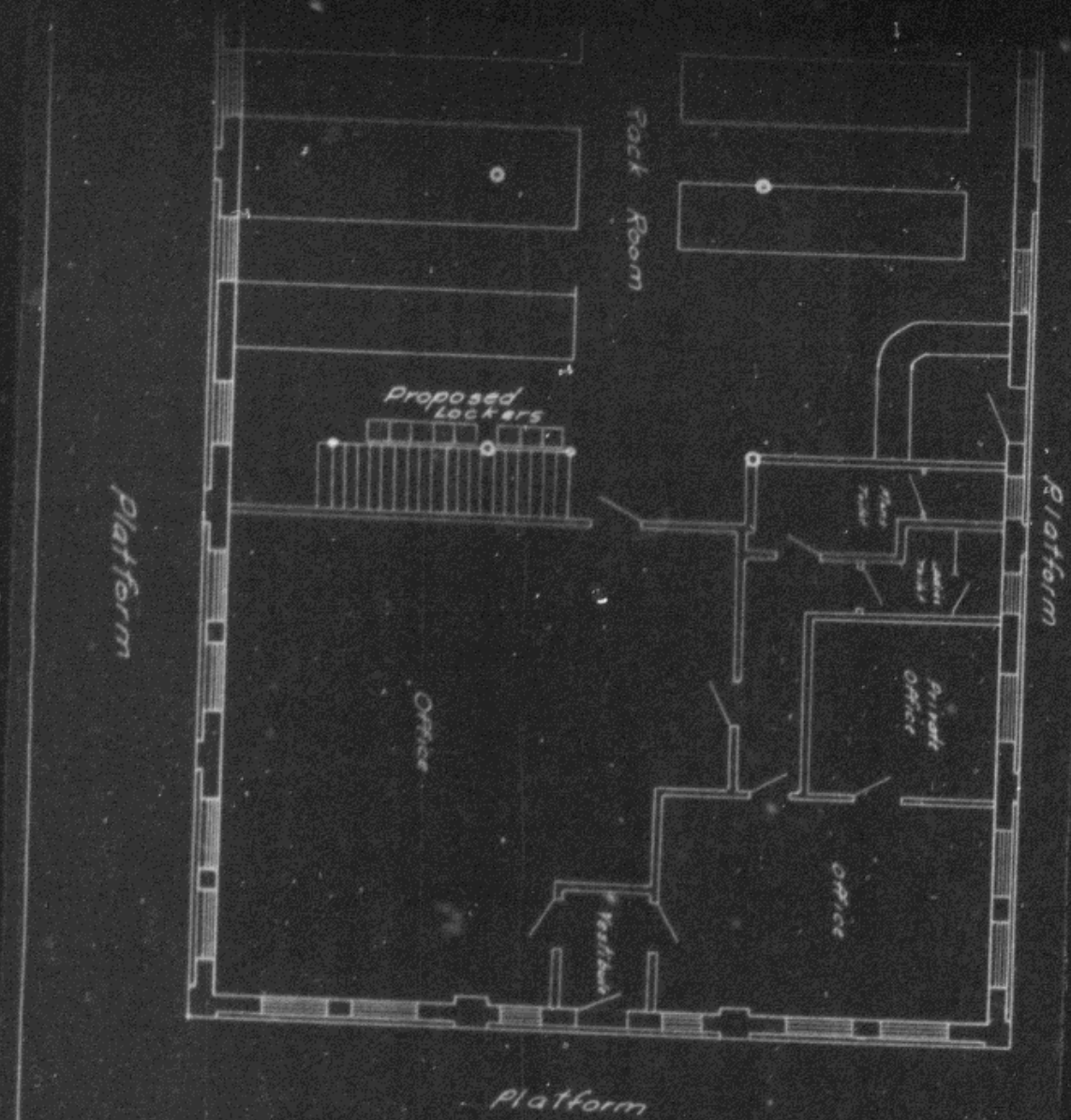

Plan of Store House
at
PARKWATER

N.P. Ry.
Idaho Div. 2nd Subdiv.
Wash Valuation Sect. 1 B.
Prop'd. lockers in Storehouse at
PARKWATER
Office Dist Engr. Spokane 12-19-21
Scale 1/8"=10'