

1923

# NORTHERN PACIFIC RAILWAY COMPANY

AUTHORITY FOR EXPENDITURE

Year: 1922 **1923**

Superintendent's No. **111**  
No.

Dept. No. **Engineering Dept. No. 133(22)**

A. F. E. No. **23**

**IDAHO** Div.

**Second** District State **IDAHO**  
Branch

Val. Sec. No. 1-B

**AUTHORITY IS REQUESTED FOR A NET EXPENDITURE OF \$ 10,725**

Accounting distribution as follows: (Distribution to be made in General Office.)

	Operating Expenses	Profit and Loss	Net Operating Expenses	Net Profit and Loss
Cost of property retired . . . \$	\$	\$	\$	\$
Value of salvage . . . . .				
Incidental costs . . . . .				
Total to Operating Expenses . . . . .				
Total to Profit and Loss . . . . .				
To Material and Supplies . . . . .				
To Bills for Collection . . . . .				
To Bills for Collection . . . . .				
To Other Accounts . . . . .				
Net charge to investment account—Additions and Betterments . . . . .				10725
Total of distribution . . . . .				\$ 10725



Budget reference: *Not in Budget*

Class of Work: No.

Joint facility contract reference: *not given*

The location is \_\_\_\_\_ on this company's property. To secure rights, it will be necessary

Location: **Parkwater, Washington.**

Title **Estimated cost of board fence around engine terminals.**

Reason: **During the early period of the recent shop men's strike an 8' board fence was constructed for the protection of our terminals at Parkwater. It is recommended that this fence be retained permanently, this RFA being submitted for that purpose.**

Checked and Entered  
President's Office

Completed  
Work to be done by company force under charge of \_\_\_\_\_  
contract  
Accounting to concentrate in the office of \_\_\_\_\_  
Signature and Title: **Superintendent.**

*District Engr*  
~~Superintendent~~  
*District Engineer*  
~~Superintendent~~

Date **Dec. 16th 1922**

APPROVED:

<i>[Signature]</i> General Superintendent.	<i>[Signature]</i> Prin. Asst. Engr. or Engr. in Charge of Work	<i>[Signature]</i> Assistant General Manager.
<i>[Signature]</i> Mech. Supt., Supt. Telgh. or Signal Engr.	<i>[Signature]</i> Chief Engineer.	<i>[Signature]</i> General Manager.
<i>[Signature]</i> For Comptroller.	<i>[Signature]</i> President.	<i>[Signature]</i> Vice-President.

Date of Final Approval } **Dec 23 19**

COMPTROLLER'S RECORD OF NOTICE OF APPROVAL AND OF COMPLETION

Form No. 1345 issued **1-12** 19 **22** Work begun 19 **22** Work finished 19 **22**

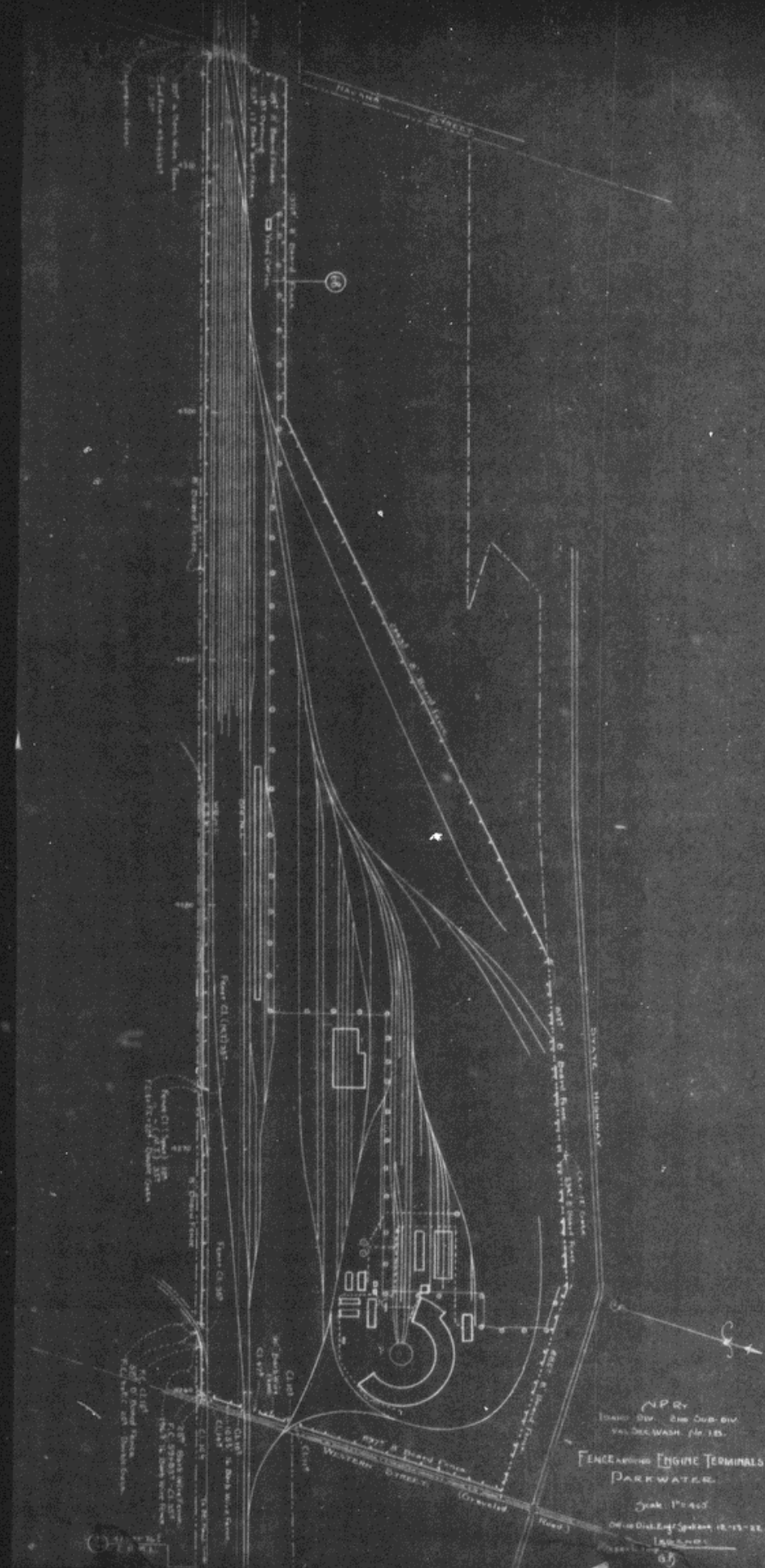

N.P.R.  
 LOANED DEP. 2ND DIST. DIV.  
 VAL. DEC. WASH. FILE 185.

**FENCE AND ENGINE TERMINALS  
 PARK WATER.**

Scale 1" = 40'  
 Office Dist. Eng. Systems 12-15-22  
 185-200  
 05