

**NORTHERN PACIFIC RAILWAY CO.**  
 AUTHORITY FOR EXPENDITURE

Year: 1923

Superintendent's No. **220** Dept. No. Engineering Dept. No. **13 (23)** A. F. E. No. **2**  
 Div. **Tacoma** District State **Wash** Val. Sec. No. **28**  
 Branch **Grays Harbor Line**

**AUTHORITY IS REQUESTED FOR A NET EXPENDITURE OF \$ 651.**

Accounting distribution as follows (Distribution to be made in General Office.)

	DOCUMENT	Operating Expenses	Profit and Loss	Net Operating Expenses	Net Profit and Loss
Cost of property retired	ENTRUSTED ON		\$	\$	\$
Value of salvage	EXPENSE				
Incidental costs					
Total to Operating Expenses					\$
Total to Profit and Loss					\$
To Material and Supplies					
To Bills for Collection					50
To Other Accounts					1225
Net charge to investment account—Additions and Betterments					1876
Total of distribution					\$ 701

*See that up make 2/1/20*

Budget reference: Class of Work No. **10**

Joint facility contract reference:

The location on this company's property. To secure rights, it will be necessary

Location: **Pacific, Washington (near)**

Reason: **Hobi Brothers, lumbermen, own about three hundred million feet of timber in southeastern portion of Quinalt Indian Reservation located northerly from peninsular extension Northern Pacific Grays Harbor Line between Hoquiam and Hoopli. To enable them to log this timber and ship to Grays Harbor Mills at Hoquiam and Aberdeen, they propose to construct logging railroad and desire connection with Northern Pacific track west of Aloha. This connection recommended as per sketch and estimate herewith submitted on basis Railway Company assuming cost of construction to clearance point only. Spur track agreement, Form 802, dated December 11th 1922 attached.**

Original Cost Adjustment  
 Made in **SEP 19 1923**

Checked and Entered  
 President's Office

Work to be done by **company force** under charge of **Superintendent**

Accounting to concentrate in the office of **Superintendent**

Signature and Title: **Superintendent** Date **Dec. 13, 1922**

<b>APPROVED</b> <i>[Signature]</i> General Superintendent.	<b>APPROVED</b> <i>[Signature]</i> Prin. Asst. Engr. or Eng. in Charge of Work.	<b>APPROVED</b> <i>[Signature]</i> Assistant General Manager.
<b>APPROVED</b> <i>[Signature]</i> Mech. Supt., Supt. Telf. or Signal Engr.	<b>APPROVED</b> <i>[Signature]</i> Western Traffic Manager	<b>APPROVED</b> <i>[Signature]</i>
<b>APPROVED</b> <i>[Signature]</i> Chief Engineer.	<b>APPROVED</b> <i>[Signature]</i> General Manager.	<b>APPROVED</b> <i>[Signature]</i> Vice President.
<b>APPROVED</b> <i>[Signature]</i> For Comptroller.	<b>APPROVED</b> <i>[Signature]</i> President	Date of Final Approval } <b>19 22</b>

COMPTROLLER'S RECORD OF NOTICE OF APPROVAL AND OF COMPLETION

Form No. 1345 issued **JAN 11 1923** Work begun **19** Work finished **Feb 6 1923**

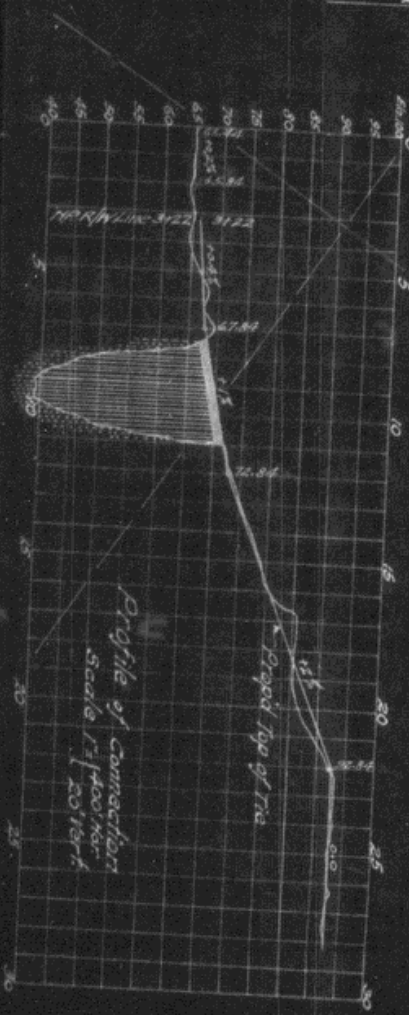

Legend  
 RR Ry. Co. ownership shown Red  
 Hotel Ry. Co. ownership shown Yellow

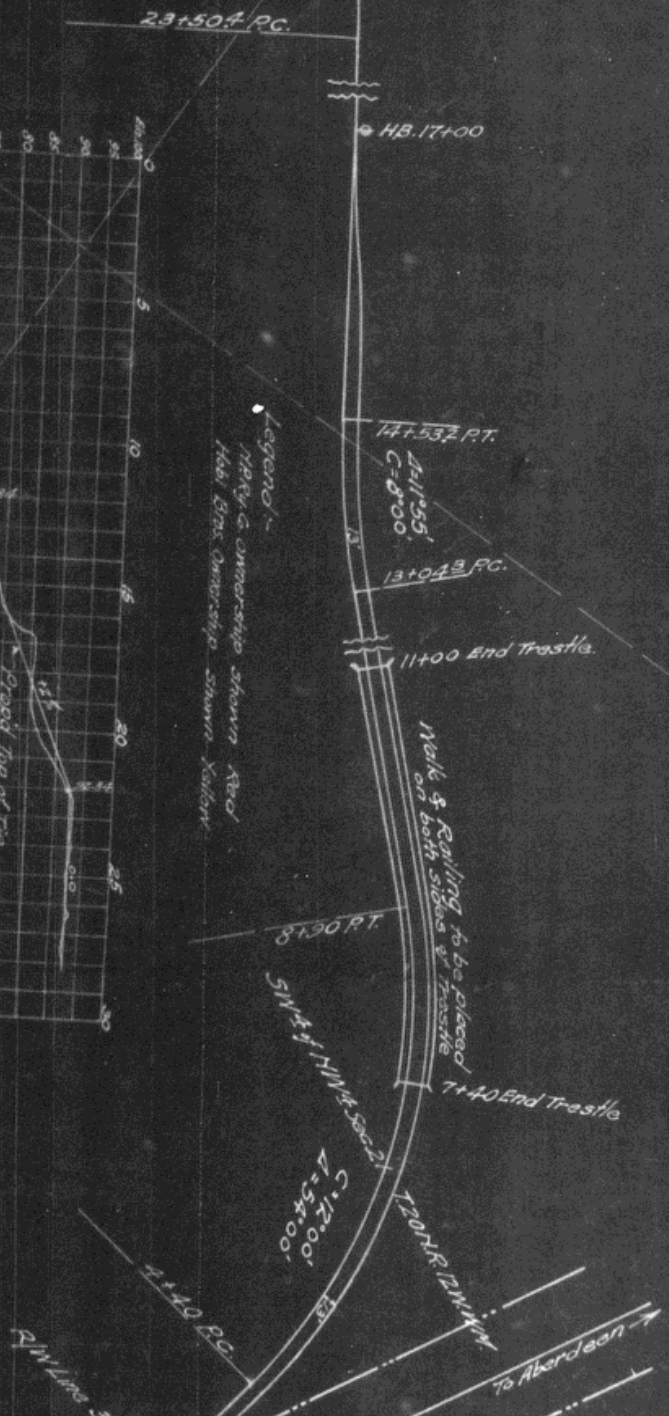

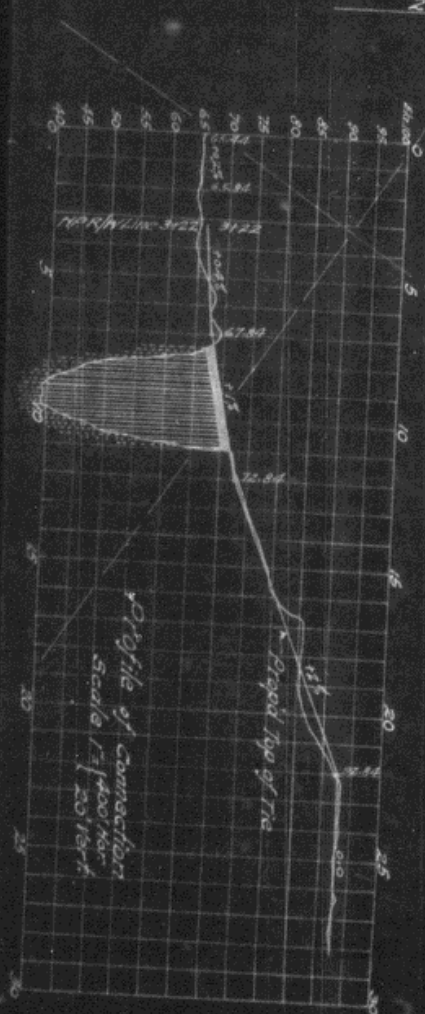

Legend:  
 N.P.R.Y. & ownership shown Red  
 Habi Bros. Ownership shown Yellow

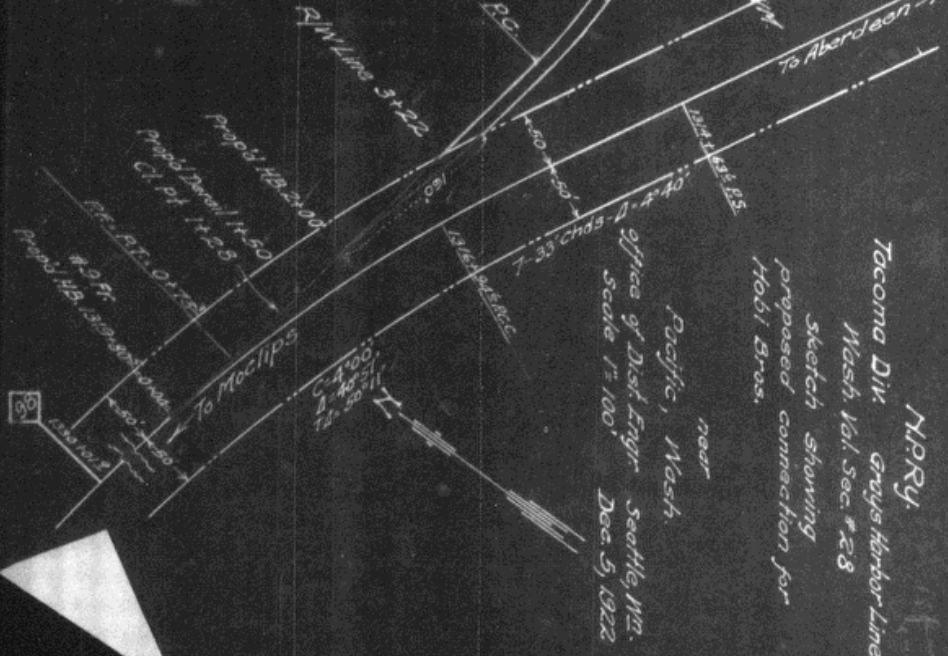
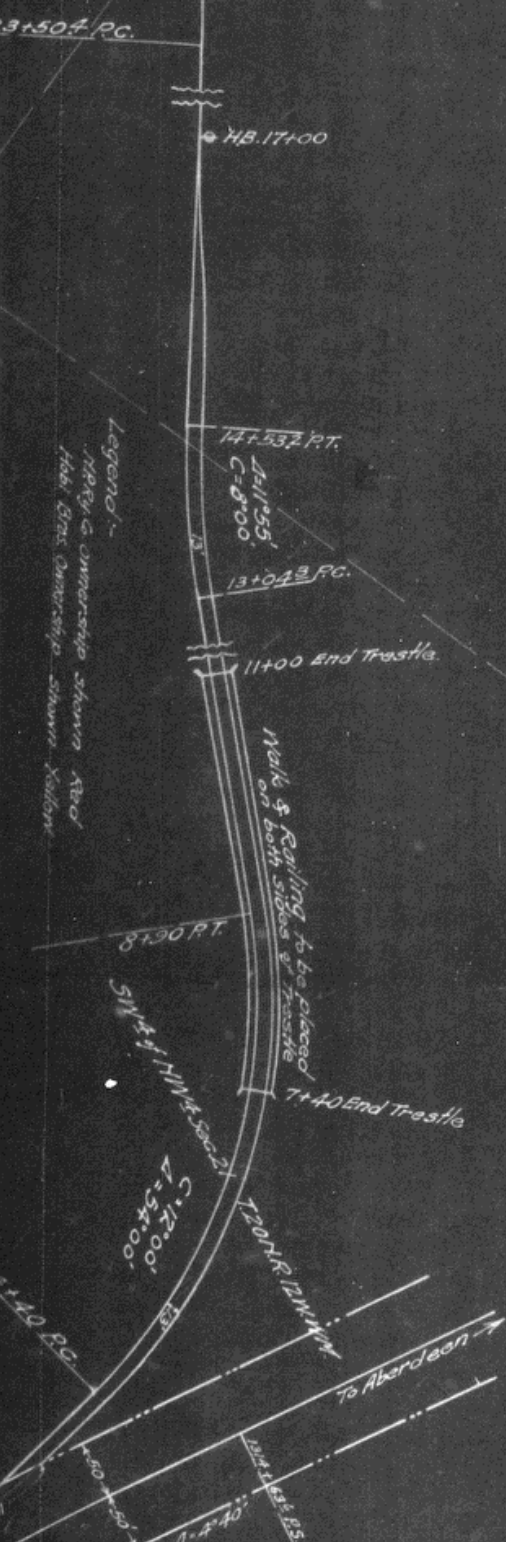

N.P.R.Y.  
 Tacoma Div. Grays Harbor Line  
 Wash. Isl. Sec. #28  
 Sketch showing  
 proposed connection for  
 Habi Bros.  
 near  
 Pacific, Wash.  
 Office of Dist. Engr. Seattle, Wn.  
 Dec. 5, 1922