

1923 Form 1363 SM 1-23 1923 1923

DULUTH UNION DEPOT & TRANSFER CO.
NORTHERN PACIFIC RAILROAD COMPANY
AUTHORITY FOR EXPENDITURE

Year: 1923 **1923**

Superintendent's No. **EB** No. **2** Dept. No. **2** Engineering Dept. No. **2** A. F. E. No. **1**

Lake Superior Div. **Duluth Terms.** District State **Minn.** Val. Sec. No. **1**

AUTHORITY IS REQUESTED FOR A NET EXPENDITURE OF \$ **2,349.00**

Accounting distribution as follows: (Distribution to be made in General Office.)

	Operating Expenses	Profit and Loss	Net Operating Expenses	Net Profit and Loss
Cost of property retired	\$ 318	\$	\$	\$
Value of salvage			318	
Incidental costs			110	
Total to Operating Expenses				\$ 428
Total to Profit and Loss				
To Material and Supplies				
To Bills for Collection				
To Other Accounts				
Net charge to investment account—Additions and Betterments				1 921
Total of distribution				\$ 2 349

Budget reference: **Not in Budget** Class of Work: No. **17**

Joint facility contract reference: **Not Joint Account**

The location is - - - on this company's property. To secure rights, it will be necessary

Location: **Duluth.**

Title **Remodel present icehouse into a refrigerator type house.**

Reason: The present depot ice house has a capacity of 1300 tons. The house is simply a shed and the ice is packed in saw dust. This condition is such that heavy repairs are required. Investigation has been made of the economy of the present type of house as compared with a refrigerator type and it is found that the present house can be remodeled into a refrigerator type house with elevator shaft, electric lights, etc., at a cost of \$2,350.00.

It is estimated that a saving in ice and labor for handling same with a refrigerator type house over the present saw dust type will be \$10,000.00 per year. The new house will also decrease the fire risk that is now present with the loose saw dust stored around the house.

Made in _____



Work to be done by ~~company force~~ under charge of **Superintendent**

Accounting to concentrate in the office of **Superintendent**

Signature and Title: *Matthew Supt* Date **August 28th 19 23**

APPROVED:	<i>Bernard Blum</i>	
General Superintendent.	Matthew or Engr. Maint. of Way.	Assistant General Manager.
Mech. Supt. Supt. Telch. or Signal Engr.		
<i>[Signature]</i>	<i>[Signature]</i>	<i>[Signature]</i>
Chief Engineer.	General Manager.	Vice President.
<i>[Signature]</i>	<i>Charles Donnell</i>	Date of Final Approval } 10 2- 23 19
For Comptroller.	President	

COMPTROLLER'S RECORD OF NOTICE OF APPROVAL AND OF COMPLETION

Form No. 1345 issued _____ 19 _____ Work begun _____ 19 _____ Work finished _____ 19 _____

NORTHERN PACIFIC RAILWAY COMPANY
 LAKE SUPERIOR DIVISION

DULUTH TERMINALS

DULUTH

STATE OF MINNESOTA.

VALUATION SEC. #1

Estimated cost of proposed remodeling Duluth
 Union Depot ice House into refrigerator type
 as per sketch dated July 24, 1923.

	LABOR	MATERIAL
<u>ADDITIONS AND BETTERMENTS</u>		
<u>STATION AND OFFICE BUILDINGS</u>		
Lumber 4700 FBM @ L 30 M 25	94	118
900 @ L 20 M 20	18	27
15500 @ L 30 M 22	310	341
Oak flooring 640 FBM @ L 30 M 55	19	35
Millwork	80	160
Hardware and nails		110
Waterproof paper	5	40
Sawdust 250 cu @ L 30 M 50	75	125
Painting exterior 30 yds @ L 25 M 30	8	6
interior 25 yds @ L 20 M 15	5	4
Electric light & wiring	25	25
	639	
Superintendence	64	
Engineering	70	
<u>MISCELLANEOUS</u>		
Fuel & repairs, etc		400
Bond, Insurance, etc		75
	773	1466
		773
		2239
 <u>OPERATING EXPENSES</u>		
Removing interior sheathing, etc	80	
Removing present ice wash room	20	
	100	
Engineering	10	
	110	
 <u>ESTIMATED ORIGINAL COST OF PROP RETIRED</u>	 318	
 <u>SUMMARY</u>	 2239	
Additions and Betterments	110	
Operating Expenses	2349	
Total		

NOT JOINT ACCOUNT

NOTE Estimated cost of doing work furnished by Chief Engineer.

J. J. J. J.
 DISTRICT ENGINEER

OFFICE OF DISTRICT ENGINEER
 SAINT PAUL, MINNESOTA.
 AUGUST 21, 1923. JTD # 464

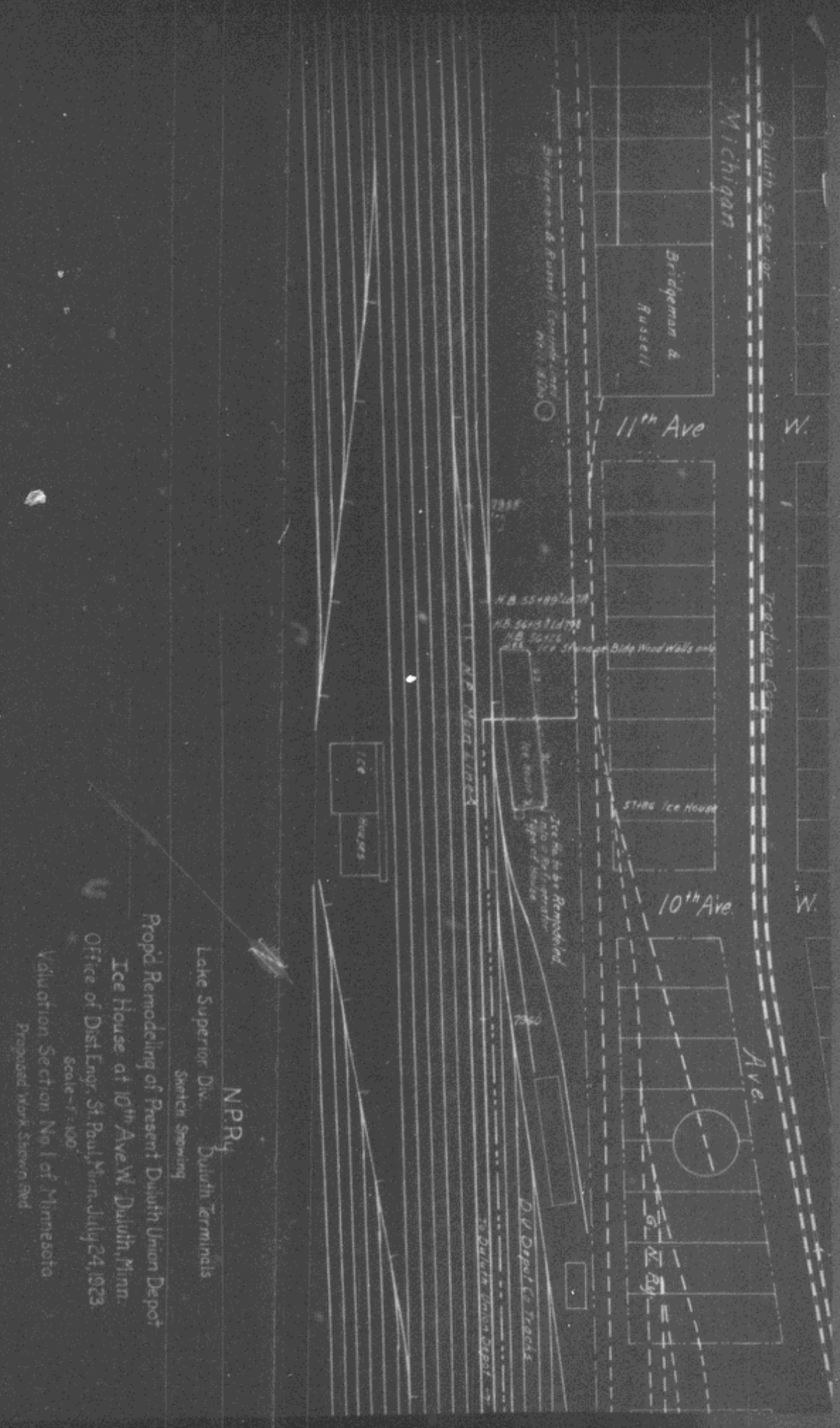

Prop'd Remodeling of Present Duluth Union Depot
 Ice House at 10th Ave. W. Duluth, Minn.
 Office of Dist. Engr. St. Paul, Minn. July 24, 1923.
 Scale - 1/4" = 1'-0"
 Valuation Section No. 1 of Minnesota
 Proposed Work Steven Emd

N.P.R.R.
 Lake Superior Div. Duluth Terminals
 Switch Spawning

D & G Depot Co. Tracks

Duluth Union Depot

Duluth Superior
Michigan

Trasken Court

11th Ave

10th Ave

Ave.

Bridgeman &
Russell

5186 Ice House

N.B. 55+89 1/2 78
N.B. 56+75 3/4 78
N.B. 56+75 1/2 78

Ice Storage Bldg Wood Walls only

See file in the Remodeled
Ice House
Type of House

ICE
HOUSE

N.P. VERT. LINES

7885

W.

W.