

1921

1921  
COMPTROLLER'S COPY

# NORTHERN PACIFIC RAILWAY COMPANY

## AUTHORITY FOR EXPENDITURE

Year: 1920

1921

Superintendent's No. **179**  
No.

Dept. No. **212**  
Engineering Dept. No.

A. F. E. No. -

**6**

**Montana** Div. **First**

District ~~XXXXX~~ State **Montana** Val. Sec. No. **3**



AUTHORITY IS REQUESTED FOR A NET EXPENDITURE OF \$ **494.**

Detailed distribution as follows: (Distribution to be made in General Office.)

	Operating Expenses	Profit and Loss	Net Operating Expenses	Net Profit and Loss
Cost of property retired	\$	\$	\$	\$
Value of salvage				
Incidental costs				
Total to Operating Expenses				
Total to Profit and Loss				
To Material and Supplies				
To Bills for Collection				
To Other Accounts				
Net charge to investment account—Additions and Betterments				
Total of distribution				\$ <b>603</b>

*Great Western Sugar Co. of Livingston, Park City, 606. Working on spur track to be made.*

Budget reference: **In Budget**

Class of Work: No. **10**

Joint facility contract reference: **Not joint facility**

The location is ----- on this company's property. To secure rights, it will be necessary

Location: **Park City**

Title and Reason: **Extend spur for Great Western Sugar Company**

At this point present beet dump of Great Western Sugar Company was located on very low ground which is continually wet on account of seepage, making it impossible to store sugar beets at present location. The Great Western Sugar Company have relocated their beet dump at Park City and it is proposed to extend spur track built under AFE 633 of 1906 360 feet to new beet dump as per blue prints and estimates attached.

Work informally authorized as per letter Mr. A. V. Brown, General Superintendent, dated August 16th, 1920.

Work completed August 25th, 1920.

Checked and Entered  
President's Office



Work ~~XXXXXX~~ completed by company force ~~XXXXXX~~ under charge of **Division Superintendent**

Accounting to concentrate in the office of **Superintendent, Livingston.**

Signature and Title: *Mawtry* **Superintendent** Date **August 25,** 19 **20**

<i>[Signature]</i> General Superintendent.	<i>[Signature]</i> Engr. of Maint. of Way.	<i>[Signature]</i> Assistant General Manager
---	---	---

<i>[Signature]</i> Mech. Supt. or Supt. Telgh.	<i>[Signature]</i> Chief Engineer	<i>[Signature]</i> General Manager.	<i>[Signature]</i> Vice President.
---	--------------------------------------	--	---------------------------------------

<i>[Signature]</i> Comptroller.	<i>[Signature]</i> President.	Date of Final Approval { <b>11-8-21</b> } 19 <b>20</b>
------------------------------------	----------------------------------	--

COMPTROLLER'S RECORD OF NOTICE OF APPROVAL AND OF COMPLETION

Form No. 1345 issued **JAN 1 1921** Work begun **19** Work finished **19**

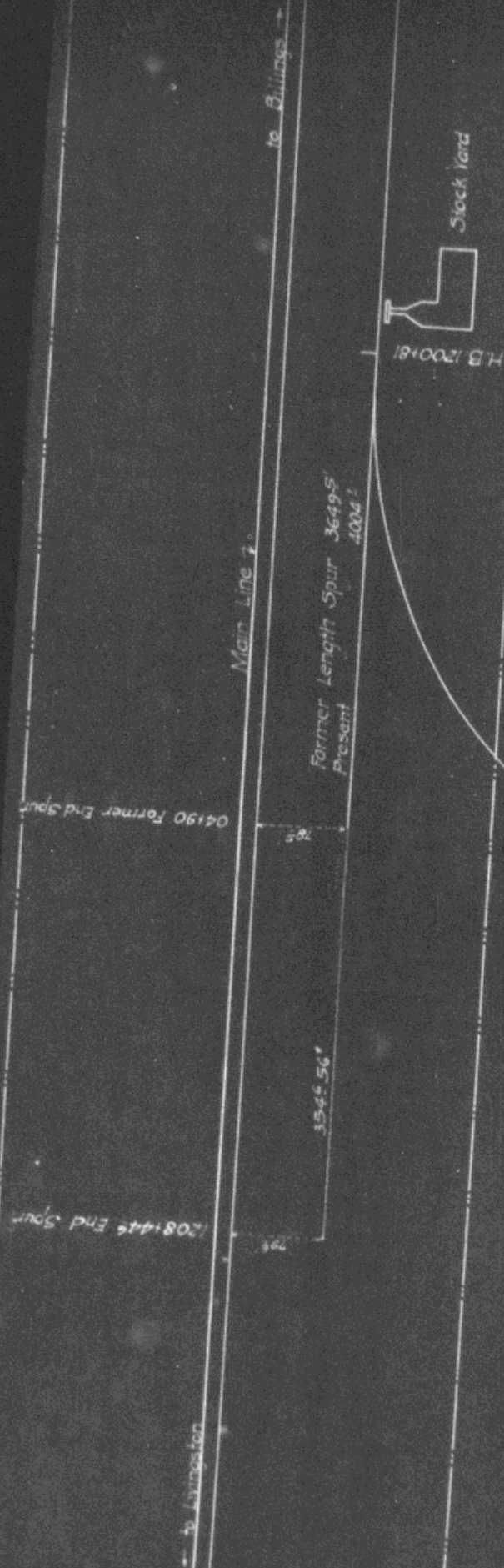

N.P.Ry. 1st District  
 Extend G.W. Sugar Co's Spur  
 at  
**Park City**  
 Scale 1:500.

Office District Engineer, Livingston, Montana, Feb. 27, 1921

Val. Section	Mont: 2
Auth. under Imp	1-8-21
Work begun	Aug. 1920
Work completed	8-5-1920

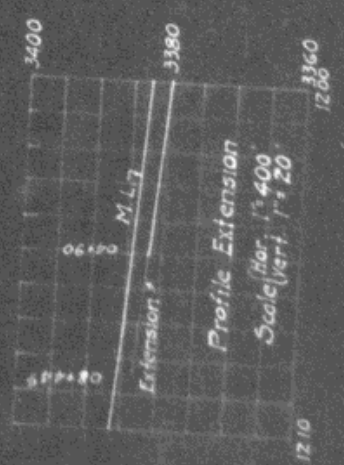

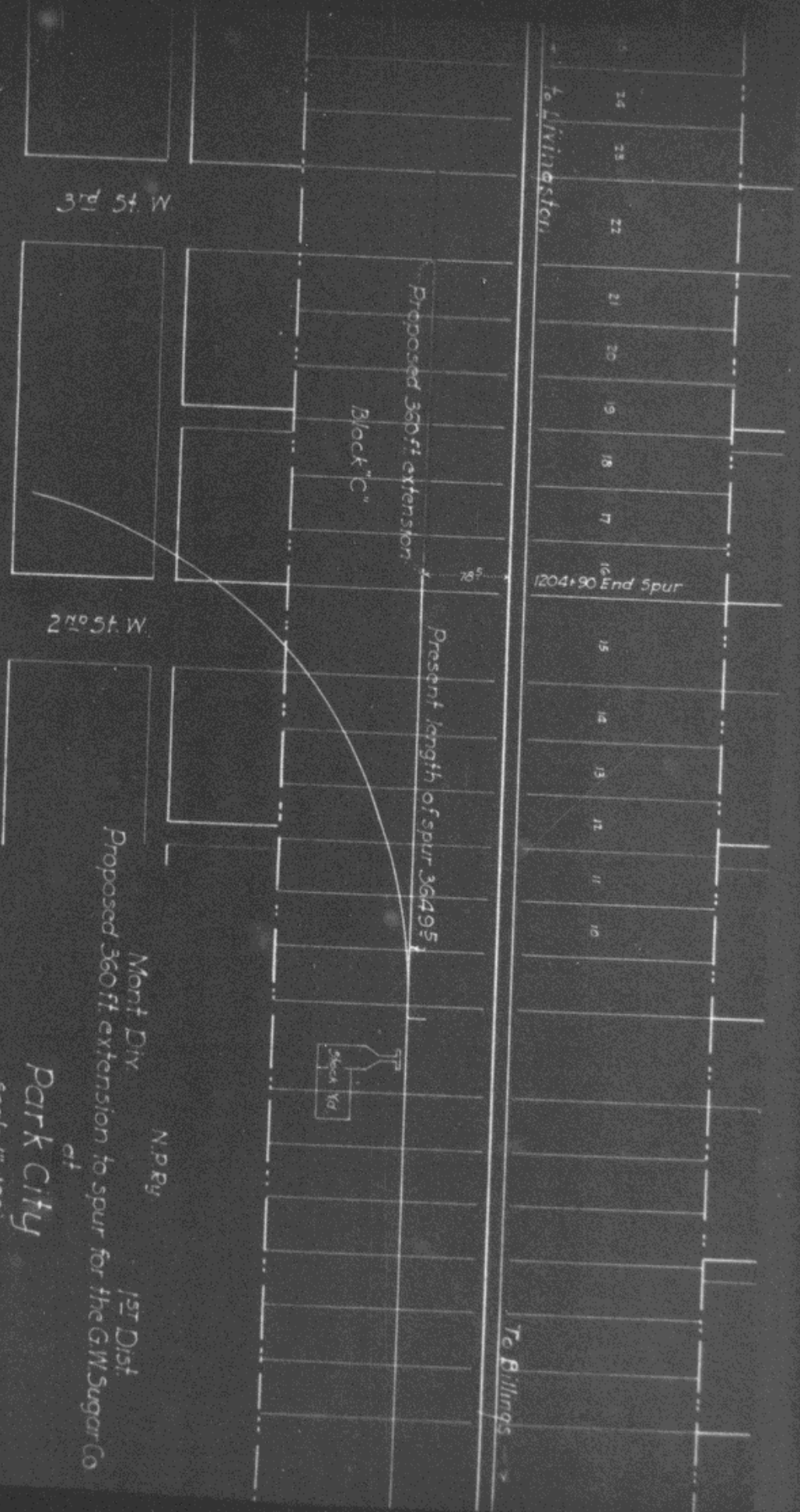

Mont Div  
 Proposed 360 ft. extension to spur for the G.W. Sugar Co  
 at  
**Park City**  
 N.P.Ry  
 1st Dist  
 Office of Dist Engr. Livingston, Mont. 8-19-1920  
 Proposed work shown red  
 Valuation Section Mont 2