

Comptroller's Copy

Form 1345 1921

DULUTH UNION DEPOT AND TRANSFER COMPANY

~~NOTHING TO BE DONE HERE~~

AUTHORITY FOR EXPENDITURE

Year: 1921

Superintendent's No. No. Dept. No. Engineering Dept. No. 3 A. F. E. No. 3

Div. District State Val. Sec. No. /

AUTHORITY IS REQUESTED FOR A NET EXPENDITURE OF \$ 115.00

Accounting distribution as follows: (Distribution to be made in General Office.)

	Operating Expenses	Profit and Loss	Net Operating Expenses	Net Profit and Loss
Cost of property retired	\$	\$	\$ 30	\$
Value of salvage				
Incidental costs			22	
Total to Operating Expenses				\$ 52
Total to Profit and Loss				
To Material and Supplies				
To Bills for Collection				
To Other Accounts				
Net charge to investment account—Additions and Betterments				63
Total of distribution				\$ 115

Budget reference: Class of Work: No. 17

Joint facility contract reference: N

The location is - - - on this company's property. To secure rights, it will be necessary

Location: Duluth

Title and Reason: Remodeling Switchmen's shanty at Duluth Union Depot

In the yards of the Duluth Union Depot there is located a switchmen's shanty which does not have sufficient clearance from an adjoining track and there is a constant hazard present on account of this insufficient clearance. The matter has been thoroughly investigated and it is found that no other location will serve the needs of the switch tenders. It has therefore been decided to re-arrange the structure to make it narrow and extend it in length so as to afford the same ground area as it is considered that the size of the building cannot be decreased.

Original Cost Adjustment Made in 19...

Checked and Entered President's Office



Work to be done by company force under charge of Superintendent

Accounting to concentrate in the office of Supt. Duluth Union Depot & Tfr. Company

Signature and Title: Superintendent Date September 16, 19 21

APPROVED:	<i>Bernard Blum</i>	
General Superintendent.	Engr. Maint. of Way.	Assistant General Manager.
Mech. Supt. or Neighbor Signal Engr.	<i>[Signature]</i>	<i>[Signature]</i>
Chief Engineer.	General Manager.	Vice President.
General Auditor of Comptroller.	<i>Charles D. [Signature]</i>	Date of Final Approval } OCT 10 1921 19
	President.	

COMPTROLLER'S RECORD OF NOTICE OF APPROVAL AND OF COMPLETION

Form No. 1345 issued 19 Work begun 19 Work finished

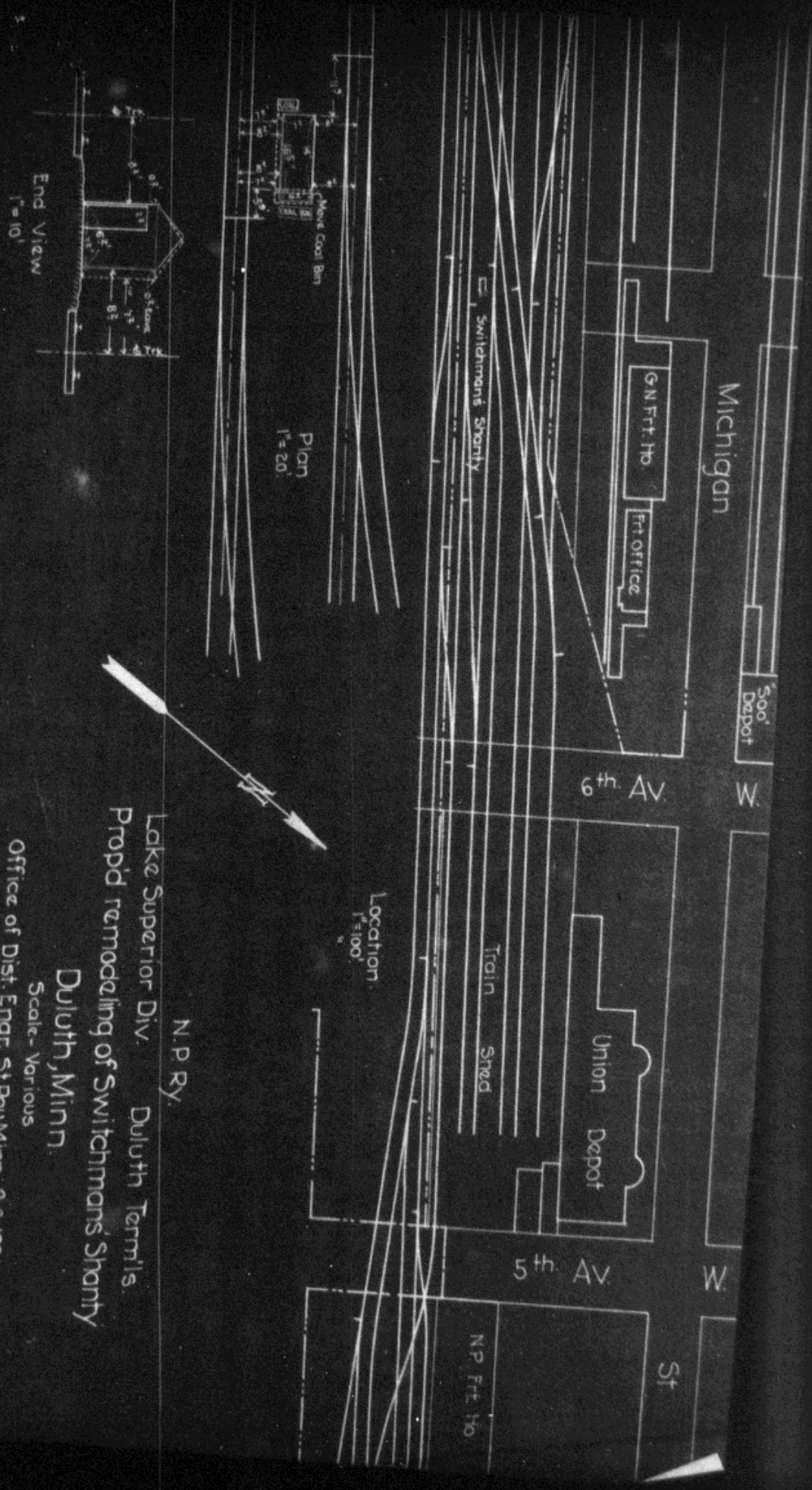

N.P. Ry.
 Lake Superior Div. Duluth Terminals
 Proposed remodeling of Switchman's Shanty
 Duluth, Minn.
 Scale - Various
 Office of Dist. Engr. St. Paul, Minn. 9-3-1921.
 Proposed Work shown Red
 Vol. Sec. No. 1. Minn.