



1918 1918

REQUISITION FOR AUTHORITY FOR EXPENDITURE

Applicant's No. of 1918 Eng. Dept. No. 2-1918 Comptroller

On Div'n or Location Dept. State of

Authority is requested for an expenditure of \$ 550.00 char follows: (Distribution to be made in General Office, St. Paul.)

To Optg. Exps. \$ To Addns. and Betts. \$ 550.00 ✓ To

for new work additions removals maintenance At N.E. Minneapolis In Budget Not in Budget

Consisting of Minneapolis. Proposed track to serve Crown Company at 13th Ave. and Tyler Street Northeast Orig



The location is not on this company's property and is not in joint territory. It will be necessary to secure easements for track off right

10

If required by Accounting Department, a detailed estimate will be furnished. The expenditure is recommended for the following reasons: (if space is not suffi

The Crown Iron Works Company is building an additional structural shop and require an additional spur track to their plant to serve the additional building. This Company has entered into contracts with the government to furnish material for construction. A contract now to be filled by this concern for five hundred tons of such material and it is expected that similar contracts will be entered into from time to time.

Arrangements are being made for the usual agreement form 624 and necessary easements covering right

Work should be commenced at once in order to complete by and be done by company force contract under charge of Superintendent

Signature and Title of Applicant: Superintendent Date of Requisition: Dec

APPROVED BY

Approval signatures: Genl. Supt., Engr. M. of W., Chief Engr., Mech. Supt. or Supt. Tdg., Firm V. Pres., Comptroller, President, Date of Final Approval

COMPTROLLER'S RECORD OF NOTICE OF APPROVAL AND OF CO

Form 1845 issued JAN 4 - 1918 Work begun 191 Work finished

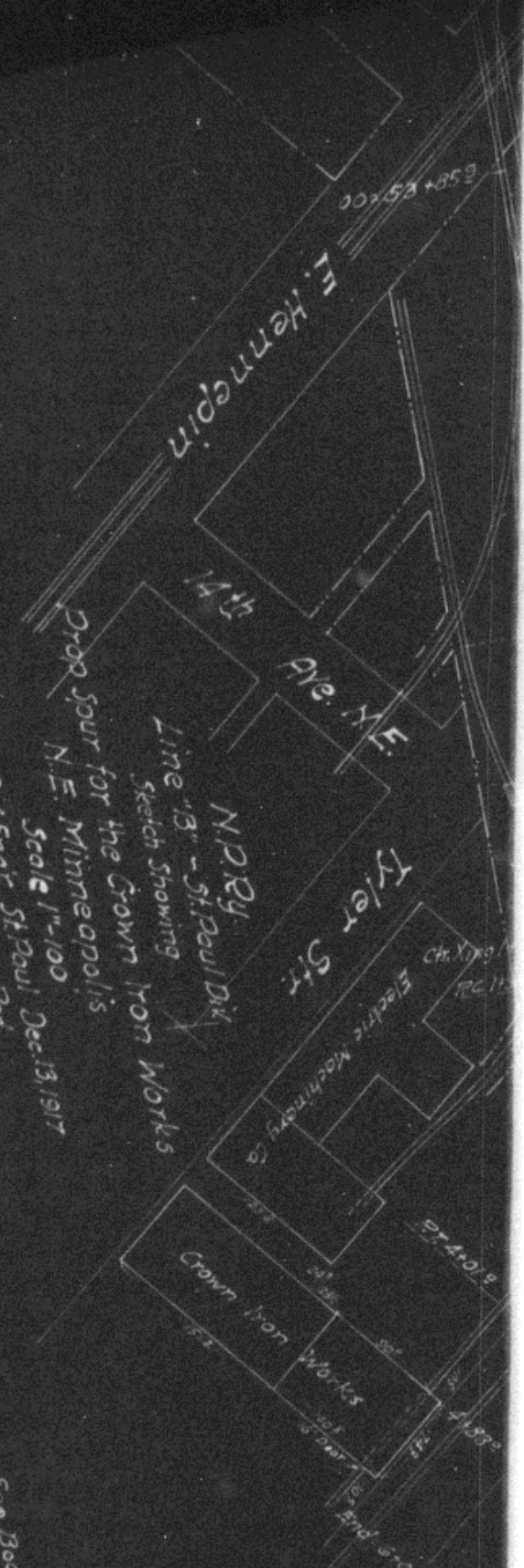

N.P.R.Y.
 Line "18" - St. Paul Div.
 Sketch Showing
 Prop. for the Crown Iron Works
 N.E. Minneapolis
 Scale 1"=100
 Office Div. Engr. St. Paul, Dec. 13, 1917
 Prop. for show Red
 Valuation Sec. No. 12 "18" Minnesota

See Book 76 Page 39

515
 515
 515
 St. Paul
 St. Paul
 St. Paul