

10-94-1912



R. F. A. No. 1 (1912)

AUTHORITY FOR EXPENDITURE.

E. D. No. 1 (1912)

Requisition dated November 21, 1911

Comptroller's No.

2

From Idaho Division Operating Department.

For Port Sherman Branch, Coeur d'Alene, Idaho (near), - fencing both sides of right of way from H.P. 10+4620 to H.P. 11+2720.

Amount, \$ 199.00

REMARKS AND RECOMMENDATIONS.

Work to be done by Division forces

Not in budget

(Idaho Valuation Section #2)

Operating Expenses	-	-	\$
Additions and Betterments	Sect. No. A-15	"	"	\$ 199.00
				\$
Material and Supplies	-	-	\$

[Signature]
Engineer Maintenance of Way.

[Signature]
Chief Engineer of Maintenance of Way.

[Signature]
Chief Engr., Mech. Supt. or Supt. Telegraph.

[Signature]
General Manager.

[Signature]
Third Vice-President.

.....
Second Vice-President.

DISTRIBUTION OF CHARGES.

Operating Expenses	\$
Additions and Betterments		199.00
Material and Supplies
Rail Renewal Fund

NOTICE RECEIVED
JAN 15 1912
OFFICE ADDR. DISKS.

Total, \$
[Signature]
Comptroller

Approved 1912 191

[Signature]
President

COMPTROLLER'S RECORD OF NOTICE OF APPROVAL AND OF COMPLETION.

Form 1345 issued JAN 15 1912 191

Work commenced

191 Work Completed

191

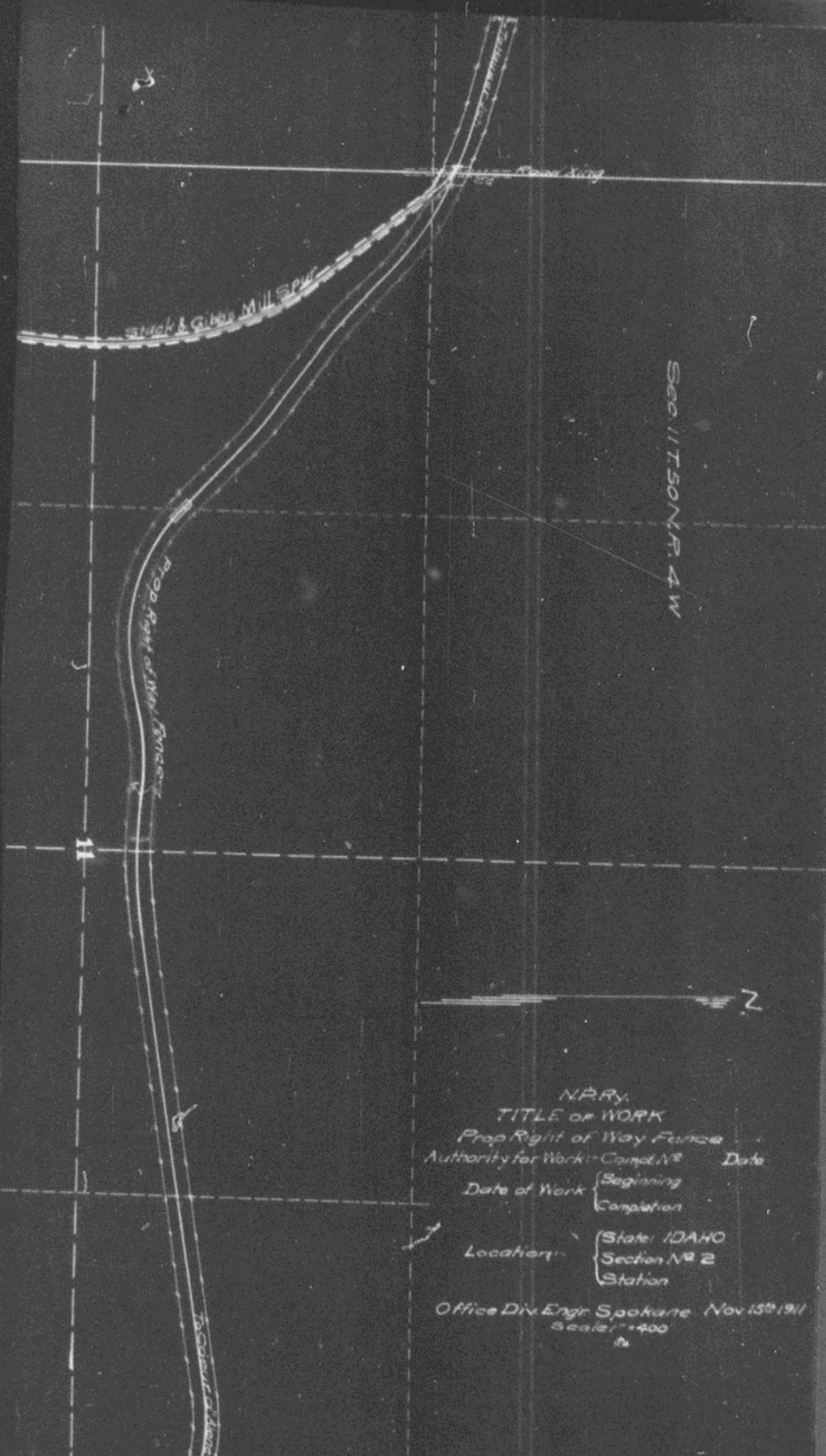

Sec. 11 T50N R. 4 W

N.R.R.
 TITLE OF WORK
 Prop. Right of Way Fence
 Authority for Work: Const. No. Date
 Date of Work { Beginning
 { Completion
 Location: { State: IDAHO
 { Section No. 2
 { Station
 Office Div. Engr. Spokane, Nov. 15th 1911
 Scale 1" = 400'
 2