



RFA No. 9

AUTHORITY FOR EXPENDITURE

F. D. No. 11  
Form 1865-A  
(Revised 12-30-06)

Requisition dated **December 24,** 190 **8**  
From **Pasco** Division **Operating** Department  
Comptroller's No. **25**

For **Prosser, rearrange present combination freight and passenger depot.**

Amount, \$ **689.00**

REMARKS AND RECOMMENDATIONS.  
**Northern Pacific Railway to stand entire expense. Work to be done by Division Forces.**

*A. P. Booth*  
Engineer, Maintenance of Way  
*Chief Engr., Maint. Dept. or Dist. Engr.*

*B. J. G. Steen*

*C. M. Lundy*  
Gen'l. Vice President.

*H. K. Nuttgren*  
General Manager.

DISTRIBUTION OF CHARGES.

Operating Expenses	<i>Info</i>	\$ <b>567.00</b>
Improvements, Betterments and Additions	<i>Info</i>	<b>228.</b>
		<b>Total \$ 689.00</b>

*W. A. Gray*  
(Comptroller) 1/30

NORTHERN PACIFIC RY. CO.  
RECEIVED  
FEB 4 1909  
P. M. S.

INSTRUCTIONS AND APPROVAL.

Approved *Jan. 29 1909*

*Samuel Elliott*  
President.

COMPTROLLER'S RECORD OF NOTICE OF APPROVAL AND OF COMPLETION.

Form 1345 Issued **FEB 6 1909** 190

Work commenced

190 Work completed

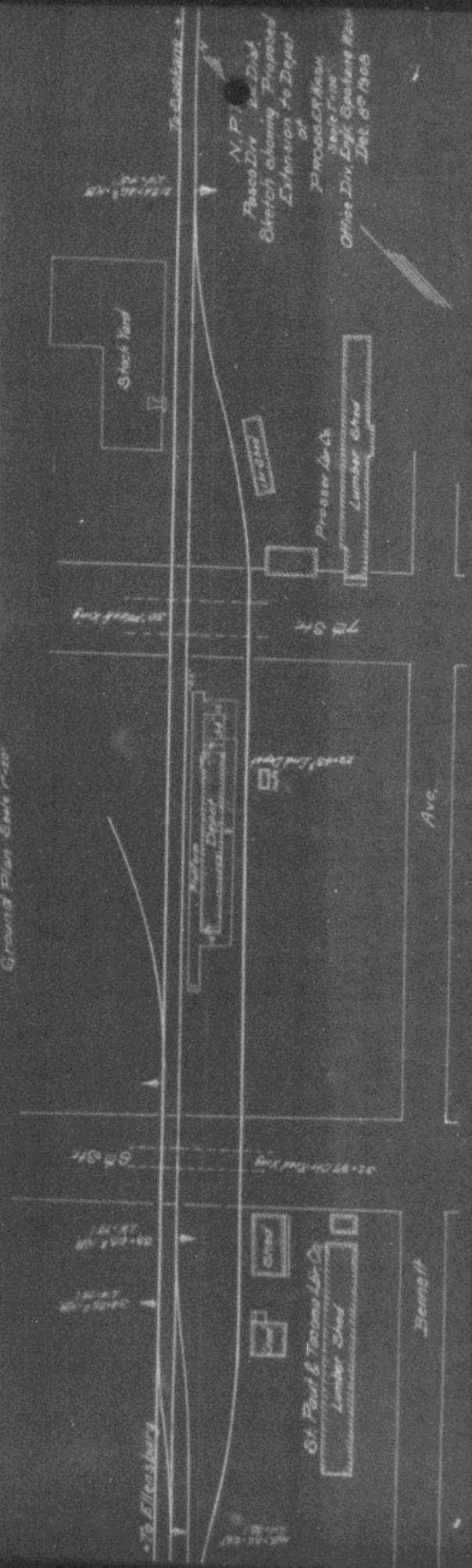



REQUISITION FOR AUTHORITY FOR EXPENDITURE.

Form 1908 (Revised 12-26-06)

Pasco, December 24th, 1908

Comptroller's No.

Pasco

Division

Operating

Department

Applicant's No. - 9 -

Authority is requested for an expenditure as per detailed estimate attached of \$ 689.00

For ~~additions~~ at Prosser,

consisting of

Re-arrange present combination freight and pass. depot

The location is shown by ~~plan attached~~ and is on ~~the~~ company's property. To secure required rights, it will be necessary

Charges are to be made against Railway Company for entire cost.

for

as per estimate of Divn. Engr. Koren dated Dec. 8th, 1908

The expenditure is recommended for the following reasons: Our business, particularly passenger, has so increased the past few years as to make it imperative to enlarge that portion of the depot, and it is intended to make separate waiting rooms, each to be 24' x 18'. At Prosser there are three operators, a clerk and warehouseman, with an office 14'6" x 18' which is much too small and force is badly cramped.

*1909 Budget item Budget estimate \$500.00  
as the work has not been done yet*

30 days will be required for construction, which should be commenced

in order to complete by as soon as possible

and be done by division forces under charge of Superintendent.

*J. J. Estess*

*A. B. Miller*

190 (Title) Supt.

17 190 (Title) Asst. Supt

DEC 24 1908

190 (Title) Divn. Engr. *KELOH* 190 (Title)

*Harry Mackley Engr*  
12/109