



AUTHORITY FOR EXPENDITURE

E. D. No. 179
1907

NPA 8764
Requisition dated

December 20th, 1907

Comptroller's No. 5

From **Pacific Division Operating Department**

For **Vancouver, 1,257 ft. spur track for Armsby Packing Company.**

Amount, \$ 1,169.00

REMARKS AND RECOMMENDATIONS.

Northern Pacific Railway Company to bear entire cost. Basement has been secured by Portland & Seattle Railway Company. (Work Completed) been

Work done by BS

[Signature]
Engineer Maintenance of Way
Chief Engr., ~~Mech. Dept. and Dept. of Equip.~~

[Signature]
Second Vice President.

[Signature]

[Signature]
General Manager.

DISTRIBUTION OF CHARGES:

Operating Expenses \$ _____

Improvements, Betterments and Additions 1169.00

Total \$ _____

[Signature]
Comptroller.

NORTHERN PACIFIC RY. CO.,
RECEIVED
FEB 10 1908
OFFICE ALPH. WILMS.

INSTRUCTIONS AND APPROVAL.

Approved FEB 6 - 1908 190

[Signature]
President.

COMPTROLLER'S RECORD OF NOTICE OF APPROVAL AND OF COMPLETION.

Form 1345 issued

113 1908

Work commenced

190

Work completed

190

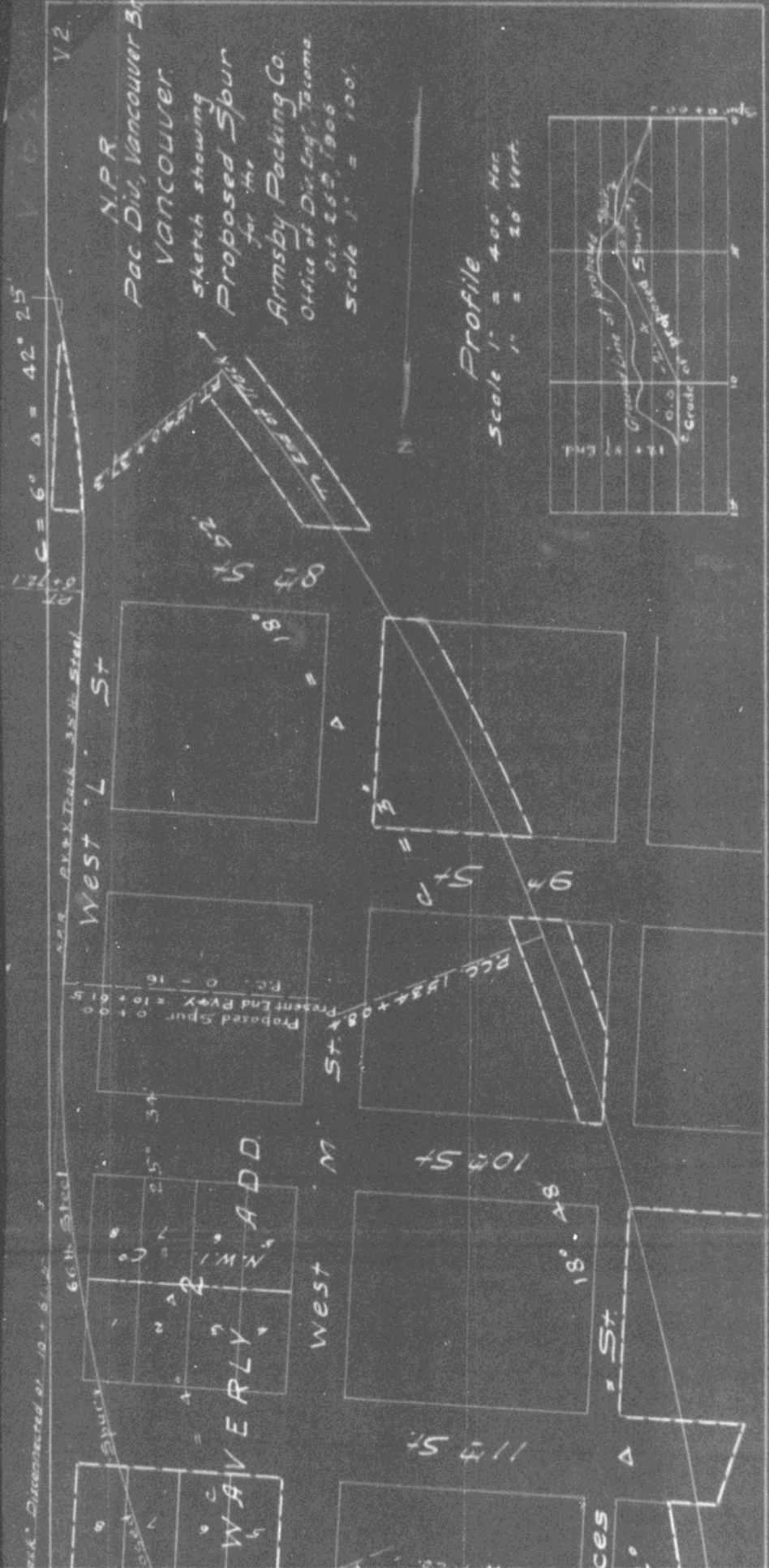

V 62
 $C = 6' \Delta = 42' 25'$
 V 2

NPR
 Pac Div, Vancouver B.C.
 Vancouver
 Sketch showing
 Proposed Spur
 for the
 Armsby Packing Co.
 Office of Div Eng, Tacoma
 Oct 26, 1906
 Scale 1" = 100'

Profile
 Scale 1" = 400' Hor
 1" = 20' Vert



1363RL

1363RL

