

Fig. 874—Northern Pacific All-Steel Dynamometer Car Built at Como Shops, St. Paul, Minn., Weight 168,000 lb.; Capacity for Drawbar Pull of 250,000 lb. and Buffing Shock of 1,250,000 lb.

(Railway Age, Feb. 9, 1929—Railway Mechanical Engineer, Mar., 1929)

(See also Figs. 862, 863 and 875)

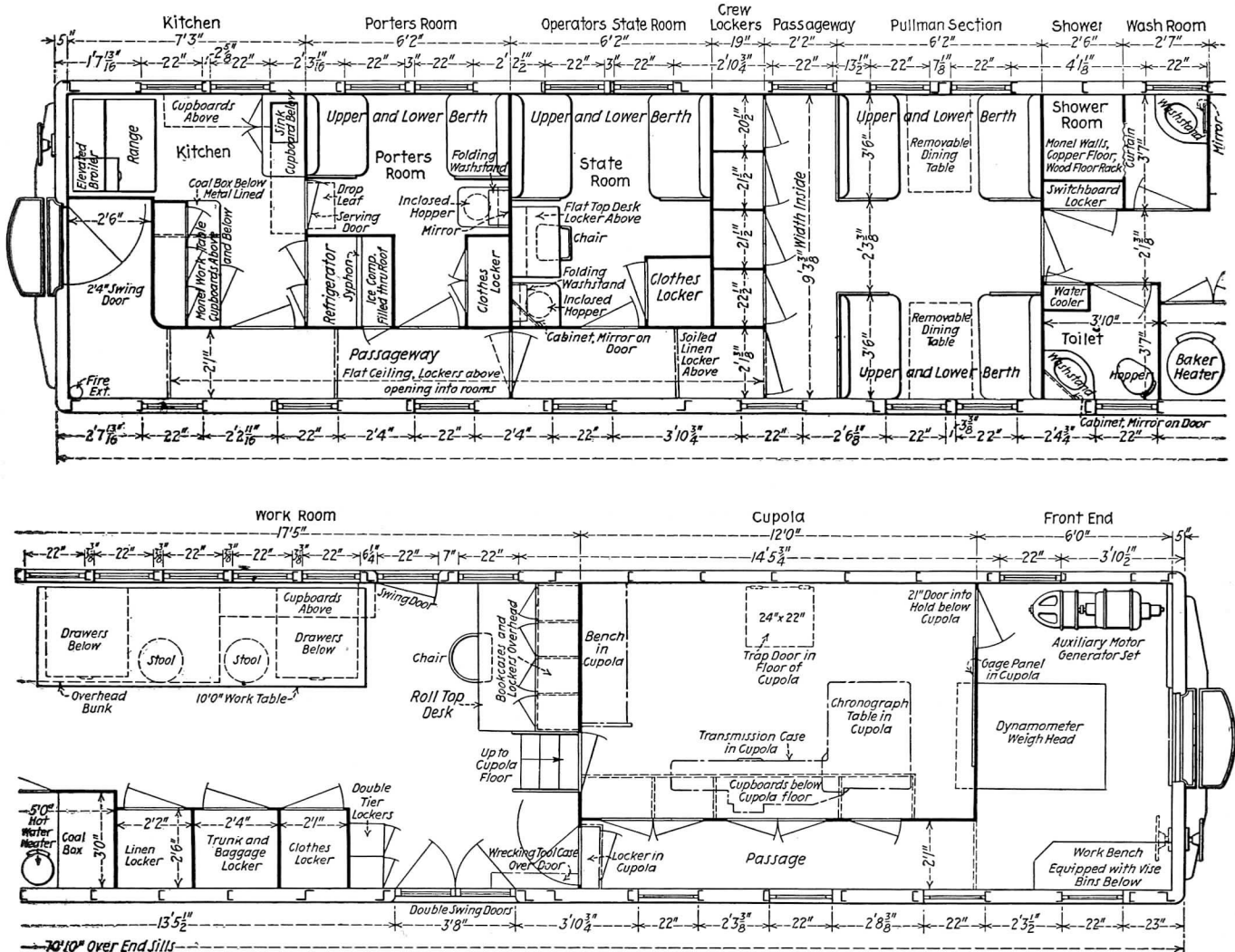

Fig. 875—Floor Plan of Northern Pacific Dynamometer Car Showing Arrangement of Accommodations and Apparatus.