

NORTHERN PACIFIC RAILWAY COMPANY 1924

AUTHORITY FOR EXPENDITURE

Superintendent's No. **146**
No.

Dept. No. **7**
Engineering Dept. No.

Year: **1924**
A. F. E. No. **23**

Seattle Div. **Darrington** Branch **State Wash** Val. Sec. No. **25**

AUTHORITY IS REQUESTED FOR A NET EXPENDITURE OF \$**Blank**

Accounting distribution as follows: (Distribution to be made in General Office.)

	Operating Expenses	Profit and Loss	Net Operating Expenses	Net Profit and Loss
Cost of property retired	\$	\$	\$	\$
Value of salvage				
Incidental costs				
Total to Operating Expenses				
Total to Profit and Loss				
To Material and Supplies				
To Bills for Collection				
To Other Accounts				
Net charge to investment account—Additions and Betterments				
Total of distribution				\$ 1196

DEPRECIATION DOCUMENT 11180 ENTERED ON EXHIBIT E

1196 ✓
327 ✓
3387 ✓
1196 ✓

Budget reference: *In 1924 Budget*

Class of Work: No. **10**

Joint facility contract reference:

The location is on this company's property. To secure rights, it will be necessary to make adjustments

Location: **Halterman, Wn.**
Track increase 1062.5 ft
Siding and Spur for Elliott Logging Co.

Title and Reason:

Mr. F. H. Elliott of the Elliott Logging Company has about two and one-half million feet of logs which he wishes to log and load on cars at a point just west of Halterman. It is proposed that he provide a siding for handling the loads and empties as well as the spur on which to load, all expense to be borne by the Elliott Logging Co.

TO BE PAID FOR BY ELLIOTT LOGGING CO. AND OWNED BY N.P.RY.

Industrial track agreement form 802 signed by Mr. F. H. Elliott December 6th, 1923 owner and manager of the Logging Co. attached.

Work to be done by company force under charge of Divn. Supt.

Accounting to concentrate in the office of Div. Supt.

Signature and Title: *Hautrey* Supt. Date **12/18/23** 19 **23**

APPROVED: <i>A. P. Brown</i> General Superintendent.	<i>A. P. Brown</i> Prin. Asst. Engr. or Engr. Maint. of Way.	<i>J. J. Woodworth</i> Assistant General Manager.
<i>H. J. Gentry</i> Mech. Supt., Supt. T'igh. or Signal Engr.	<i>H. J. Gentry</i> Chief Engineer.	<i>J. J. Woodworth</i> General Manager.
<i>J. J. Woodworth</i> For Comptroller.	<i>Charles Amundson</i> President.	Date of Final Approval } 1 10 24 19 23

COMPTROLLER'S RECORD OF NOTICE OF APPROVAL AND OF COMPLETION

Form No. 1345 issued *Jan 12* 1924 Work begun 19 Work finished *May 15*, 1924

13000
3-2-23

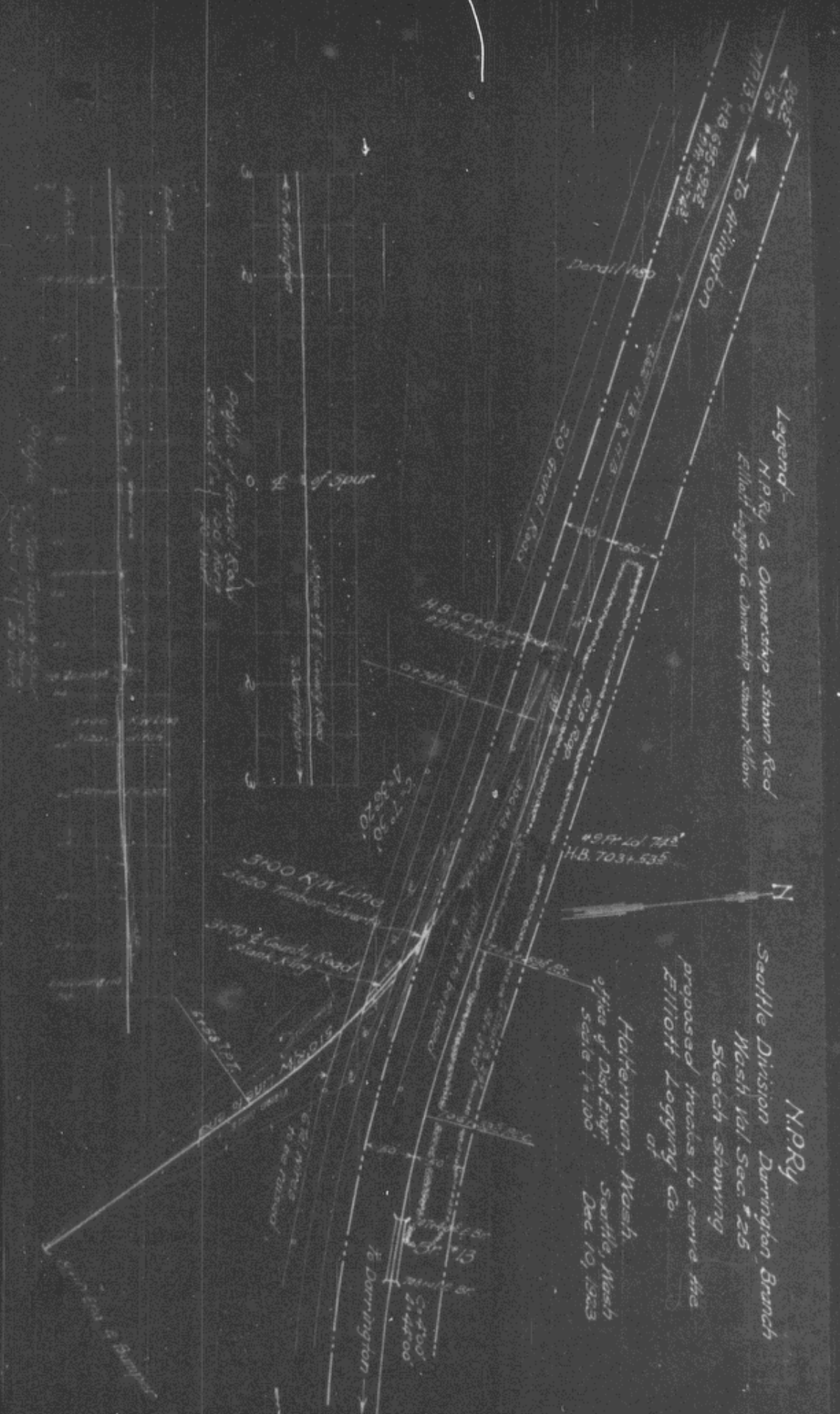

Legend-
 N.P.Ry. & Ownership shown Red
 Elliott Logging & Ownership shown Yellow

N.P.Ry.
 Seattle Division Darrington Branch
 Wash. 1st. Sec. # 25
 Sketch showing
 proposed tracks to serve the
 Elliott Logging Co.

Harker, Wash.
 District Engineer
 Seattle, Wash.
 Dec 19, 1923

of spur
 Public gravel Road
 station #1 20.000
 station #2 20.000

3100 Riv. Line
 2100 timber line
 3170 & Gandy Road
 2100 Riv. Line

To Darrington
 2144.00
 2144.00