

1924

1924

NORTHERN PACIFIC RAILWAY COMPANY

AUTHORITY FOR EXPENDITURE

Year: 1923

Superintendent's No. 83. Dept. No. Engineering Dept. No. 109

A. F. E. No. 19

I D A H O Div. Second District State Wash. Val. Sec. No. 1-B

AUTHORITY IS REQUESTED FOR A NET EXPENDITURE OF \$ 11648.

Accounting distribution as follows: (Distribution to be made in General Office.)

	Operating Expenses	Profit and Loss	Net Operating Expenses	Net Profit and Loss
Cost of property retired	\$	\$	\$	\$
Value of salvage				
Incidental costs			1450.	
Total to Operating Expenses				\$ 1450.
Total to Profit and Loss				
To Material and Supplies				
To Bills for Collection				
To Other Accounts				10198.
Net charge to investment account—Additions and Betterments				
Total of distribution				\$ 11648.



Budget reference: Not in Budget Class of Work: No

The location is on this company's property. To secure rights, it will be necessary

Location: Parkwater, Wash.

Title and Reason: Disposition of temporary strike camp buildings.

To take care of the strike camp emergency last year, we constructed at Parkwater terminals for housing new employes:

- 3 double bunk houses 40 x 82'
- 1 double bunk house 20 x 82'
- 1 mess house 40 x 122'
- 1 guard office & wash room 16 x 24'
- 1 coal shed 6 x 40'
- 1 water closet 8 x 19'

It is recommended that two of the larger bunk houses and the small double bunk house be moved and placed opposite the Parkwater car shops, as shown on the attached print, these buildings then to be used as a paint shop and for storing car material.

The third large double bunk house should be moved to the material yard, as recommended by the General Storekeeper, for the storage of B&B lumber and cement.

There being no need at the present time for the other buildings, that is, the mess house, guard office, coal shed and water closet, it is recommended that these be left at their present location for the present until such time that they may be needed. (Over)

Work to be done by company force under charge of Superintendent.

Accounting to concentrate in the office of Division Accountant.

Signature and Title: [Signature] Date Sept. 27th, 1923

APPROVED: [Signature] General Superintendent. [Signature] Prin. Asst. Engr. or Engr. Maint. of Way. [Signature] Assistant General Manager.

[Signature] Mech. Supt., Supt. Telg. or Signal Engr. [Signature] General Storekeeper

[Signature] Chief Engineer. [Signature] General Manager. [Signature] Vice-President.

[Signature] For Comptroller. [Signature] President. Date of Final Approval } 11-24-19



COMPTROLLER'S RECORD OF NOTICE OF APPROVAL AND OF COMPLETION

Form No. 1345 issued Jan 11 1924 Work begun 1924 Work finished July 30 1924

Original Cost of 4 bunk houses
Estimated cost to move buildings
Estimated cost to rebuild in kind

\$10198.
1450.
7025.

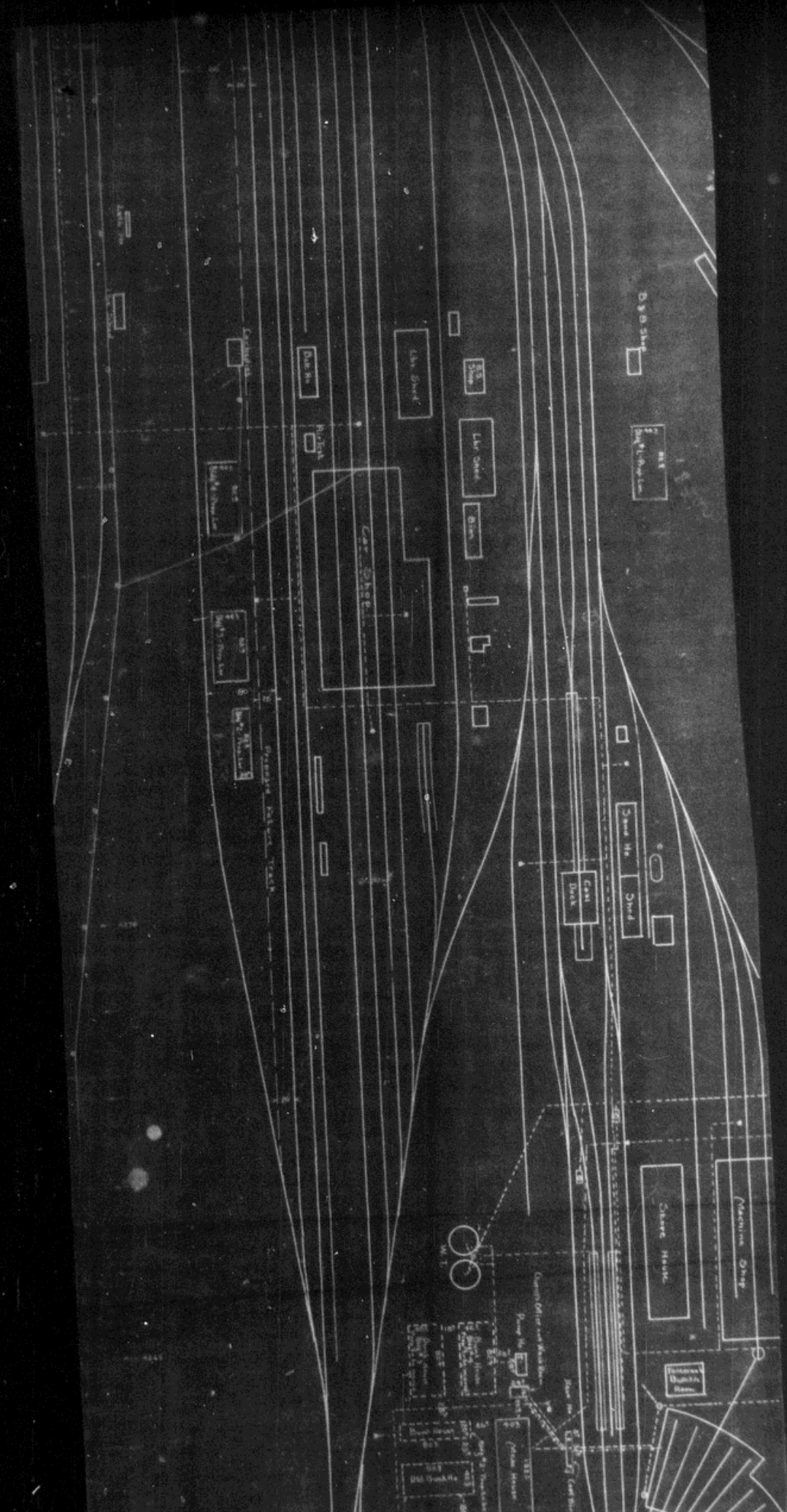

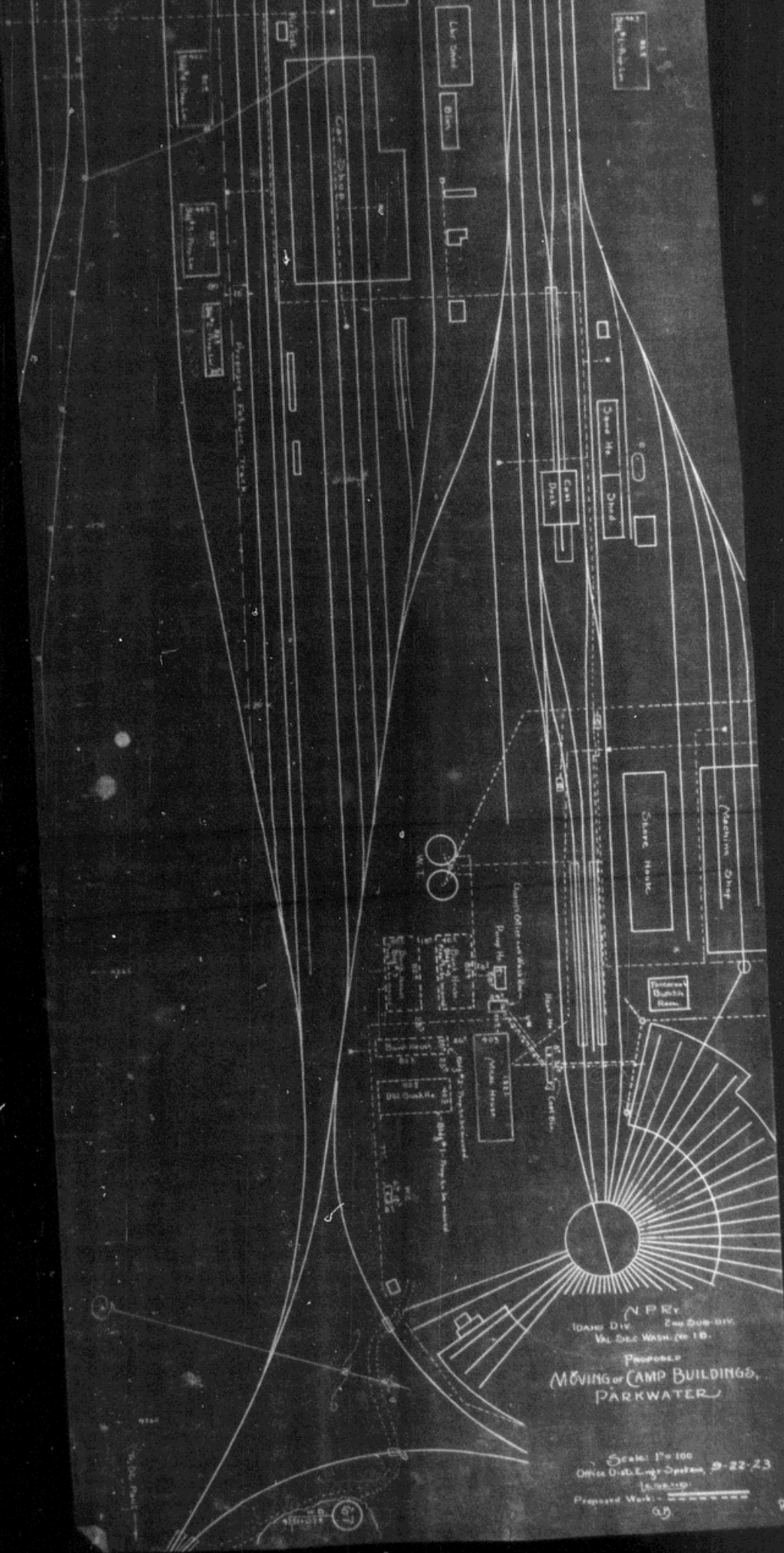

N.P.R.V.
 IDAHO DIV. 2nd Sub-Div.
 Val. Sec. Wash. Co. 1B.
 Proposed
**MOVING OF CAMP BUILDINGS,
 PARKWATER.**

Scale: 1" = 100'
 Office Dist. Engr. System, 9-22-23
 Proposed Work: _____
 65