

DULUTH UNION DEPOT AND TRANSFER COMPANY  
**NORTHERN PACIFIC RAILWAY COMPANY**  
AUTHORITY FOR EXPENDITURE

Year: 1924 **1924**

Superintendent's No.  
No.

Dept. No.  
Engineering Dept. No. **2**

A. F. E. No. **1**

Lake Superior Div.

District State Minnesota Val. Sec. No. **1**  
Branch

**AUTHORITY IS REQUESTED FOR A NET EXPENDITURE OF \$ 935.00**

Accounting distribution as follows: (Distribution to be made in General Office.)

	Operating Expenses	Profit and Loss	Net Operating Expenses	Net Profit and Loss
Cost of property retired	\$ 350.00	\$	\$	\$
Value of salvage	10.00		340.00	
Incidental costs			55.00	
<b>Total to Operating Expenses</b>				<b>\$ 395.00</b>
<b>Total to Profit and Loss</b>				<b>10.00</b>
To Material and Supplies				
To Bills for Collection				
To Other Accounts				
Net charge to investment account—Additions and Betterments				<b>540.00</b>
<b>Total of distribution</b>				<b>\$ 945.00</b>

Not in Budget  
Class of Work: No.  
Joint facility contract reference: Not joint account

The location is on this company's property. To secure rights, it will be necessary

Location: Duluth

Title and Reason: New Scale for Baggage Room

This scale to replace present scale which is located outside of Baggage room. Has a shallow pit and in the winter time, the pit seeps full of water and freezes, putting the scale out of commission during the entire winter. It is the intention to locate the new scale in the baggage room, which will prevent seepage and freezing.

Checked and Corrected  
President's Office

Original Cost Adjustment  
Made in 1924



Work to be done by company force under charge of Superintendent

Accounting to concentrate in the office of Superintendent

Signature and Title: *M. J. ...* Superintendent Date 19

APPROVED:		
General Superintendent.	Prin. Asst. Engr. or Engr. Maint. of Way.	Assistant General Manager
Mech. Supt., Supt. Telg. or Signal Engr.		
<i>[Signature]</i> Chief Engineer.	<i>[Signature]</i> General Manager	<i>[Signature]</i> Vice President
<i>[Signature]</i> Gen. Comptroller.	<i>[Signature]</i> President	Date of Final Approval } <b>MAY 28 1924</b> 19

COMPTROLLER'S RECORD OF NOTICE OF APPROVAL AND OF COMPLETION

Form No. 1345 issued *May 31* 1924 Work begun 19 Work finished 19

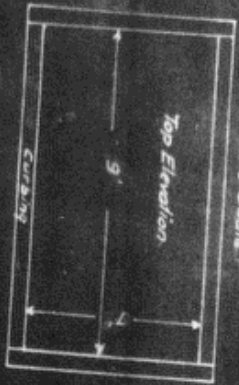
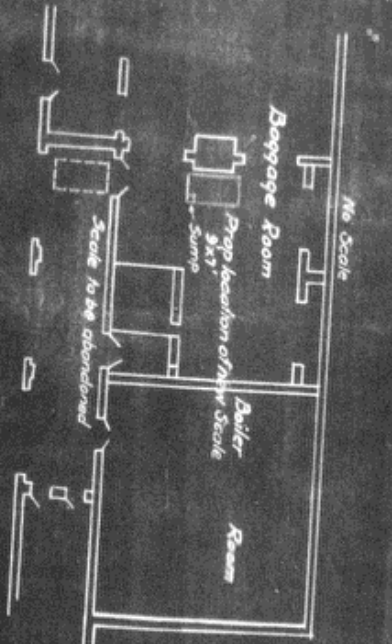

Details of Scale P1 and setting to be furnished upon approval of I. E. E.

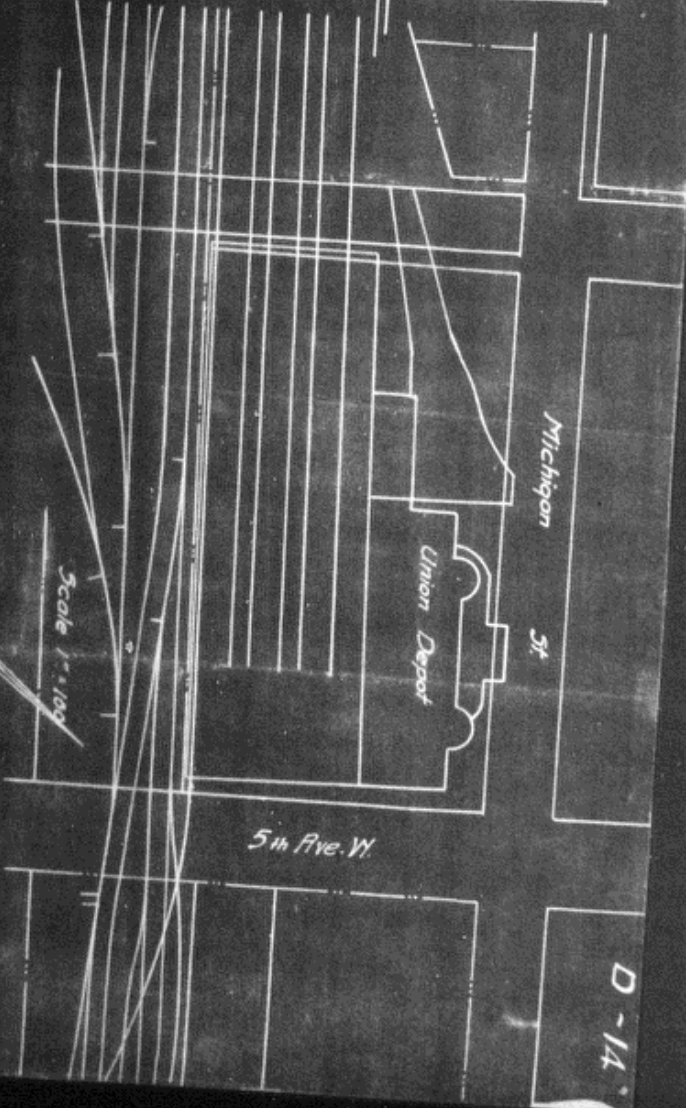

Lake Superior Div  
 Duluth Terminal  
 D. U. D. Co.  
 Prop Relocation of Baggage Room Scale  
 Union Depot - Duluth, Minn.  
 Office of Dist Engr St Paul  
 Scales as shown  
 Prop work shown red  
 Valuation Section No 1 of Minn.  
 Mar 26-1924  
 Revised 5-7-24