

1922

NORTHERN PACIFIC RAILWAY COMPANY 1922

AUTHORITY FOR EXPENDITURE

Year: 1922

Superintendent's No. **123-20**
No.

Dept. No. **9**
Engineering Dept. No.

A. F. E. No. **83**

Montana Div. **Park** Branch State **Montana** Val. Sec. No. **11**

AUTHORITY IS REQUESTED FOR A NET EXPENDITURE OF \$ 2560

Accounting distribution as follows (Distribution to be made in General Office)

DEPRECIATION DOCUMENT ENTERED ON EXHIBIT 15

| | Operating Expenses | Profit and Loss | Net Operating Expenses | Net Profit and Loss |
|--|--------------------|-----------------|------------------------|---------------------|
| Cost of property retired | \$ | \$ 6924 | \$ | |
| Value of salvage | | 4880 | | |
| Incidental costs | | | 2044 | 2044 |
| Total to Operating Expenses | | | 2044 | 2044 |
| Total to Profit and Loss | | | | 2560 |
| To Material and Supplies | | | | 4604 |
| To Bills for Collection | | | | 4880 |
| To Other Accounts | | | | |
| Net charge to investment account—Additions and Betterments | | | | 6924 |
| Total of distribution | | | | \$ 2560 |

Budget reference: **Not in Budget**

Class of Work No. **10**

Joint facility contract reference: **Not Joint**

The location is - - - on this company's property. To secure rights, it will be necessary

Location: **Electric, Montana.**

Title **Remove Mine and Coke Tracks**
and

Reason: At Electric on the Park Branch, there is considerable trackage of 56 pound rail which has not been used for a number of years and it is not likely that it will be required in the future. These tracks were placed to serve extensive coke development about 25 years ago. At the present time there is a good market for relayer 56 pound rail and our stock is so low that it will be necessary to get such material from track. We are getting about \$43.00 per ton for this rail on the Coast. It is recommended that this trackage be removed to avail ourselves of the market.

CORPORATE

Original Cost Adjustment

JUN 1922

Made in 1922

[Signature] Checked and Entered
President

[Circular Stamp]

Work to be done by ~~company force~~ under charge of **Division Superintendent.**

Accounting to concentrate in the office of **Superintendent Livingston.**

Signature and Title:

Date **January 19th,** 19 **22**

APPROVED:

| | | |
|-----------------------------|---|----------------------------|
| General Superintendent | <i>[Signature]</i> Engr. of Maint. of Way. | Assistant General Manager. |
| Mech. Supt. or Supt. Telgh. | | |
| Chief Engineer | <i>[Signature]</i> | General Manager. |
| Comptroller | <i>[Signature]</i> | Vice President. |
| | <i>[Signature]</i> | President. |

Date of Final Approval } JAN 31 1922 } 19

COMPTROLLER'S RECORD OF NOTICE OF APPROVAL AND OF COMPLETION

Form No. 1345 issued FEB 2 1919 Work begun 19 Work finished May 1922

2003 East Star

31 32
6 5

Cambridge St

To be improved

Port Branch

19

1 Feet

Sec 6 T9-S P-6E
Sec 7

2912

6 5 6

Propose

0110

10100

85

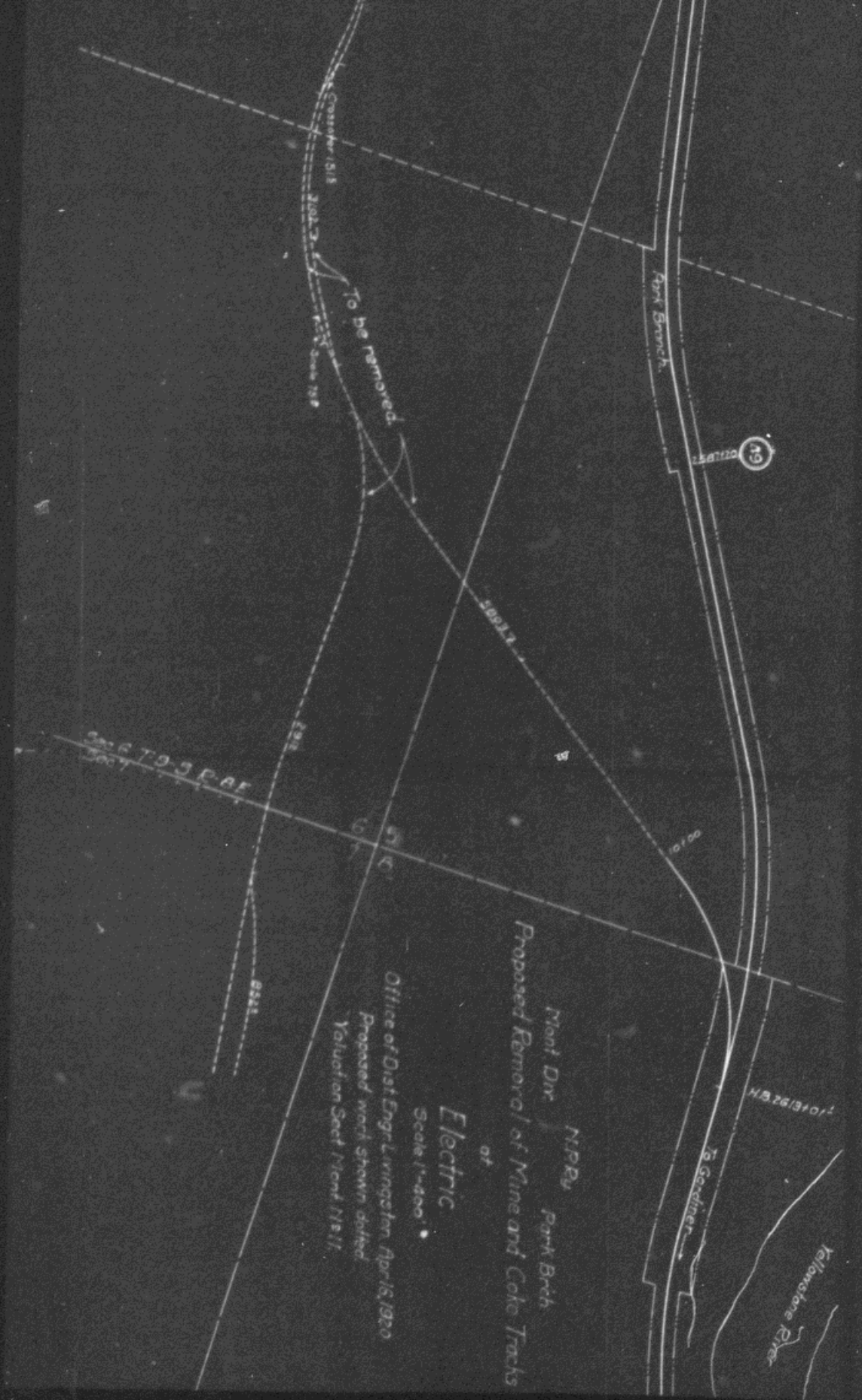

N.P.P. Park Brch
 Plant Div
 Proposed Removal of Mine and Coke Tracks
 of
Electric
 Scale 1" = 400'
 Office of Dist Engr. Livingston, April 18, 1930
 Proposed work shown dotted
 Valuation Sect. Mont. 1917.

101°13'22"E
 To Seedling
 Yellowstone River

Park Branch



300° 30' 00" W
 300° 30' 00" W
 To be removed
 100' 00"

300° 30' 00" W
 300'

100' 00"

100' 00"

100' 00"