

1922

NORTHERN PACIFIC RAILWAY COMPANY

AUTHORITY FOR EXPENDITURE

Year: 1922

Superintendent's No. 76
No.

Dept. No. Engineering Dept. No. 13(22)

A. F. E. No. 44

IDAHO Div. Fort Sherman - Branch State IDAHO

Val. Sec. No. 2

AUTHORITY IS REQUESTED FOR A NET EXPENDITURE OF \$ 209

Accounting distribution as follows: (Distribution to be made in General Office.)



	Operating Expenses	Profit and Loss	Net Operating Expenses	Net Profit and Loss
Cost of property retired	\$	\$	\$	\$
Value of salvage				
Incidental costs				
Total to Operating Expenses				\$
Total to Profit and Loss				
To Material and Supplies				
To Bills for Collection				
To Other Accounts				
Net charge to investment account—Additions and Betterments				209
Total of distribution				\$ 209

Budget reference: *Not in Budget*

Class of Work: No. 16

Joint facility contract reference: *Not joint*

The location is _____ on this company's property. To secure rights, it will be necessary

Location: **Hauser (near) Idaho.**

Title **Right of way fence through property of Thomas E. Swears.**
and

Reason: **Mr. Thomas E. Swears has recently purchased from the Spokane Valley Land and Water Company, the land abutting our right of way through the NE 1/4 of Section 29-51-5. He has fenced his property on all other sides and asks that the track sides be fenced as soon as possible. The Idaho statutes provide that every Railway Company shall erect and maintain lawful fences not less than four feet high on each side of its road where the same passes through or along enclosed or adjoining cultivated fields or enclosed lands with proper and necessary openings and gates therein and farm crossings.**

Work to be done by company force under charge of **SUPERINTENDENT**
contract

Accounting to concentrate in the office of **SUPERINTENDENT**

Signature and Title: _____ Date **December 17th 1922**

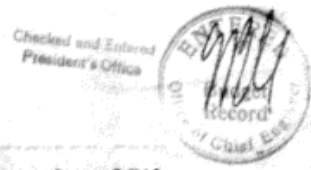

APPROVED: *A. B. Book* General Superintendent. Engr. of *12/27/22* Assistant General Manager.

Mech. Supt. or Supt. Telgh. _____
Chief Engineer. _____ General Manager. _____ Vice President.

Comptroller. _____ Date of Final Approval } **JAN 24 1922** 19
President. *Charles Amey*

COMPTROLLER'S RECORD OF NOTICE OF APPROVAL AND OF COMPLETION

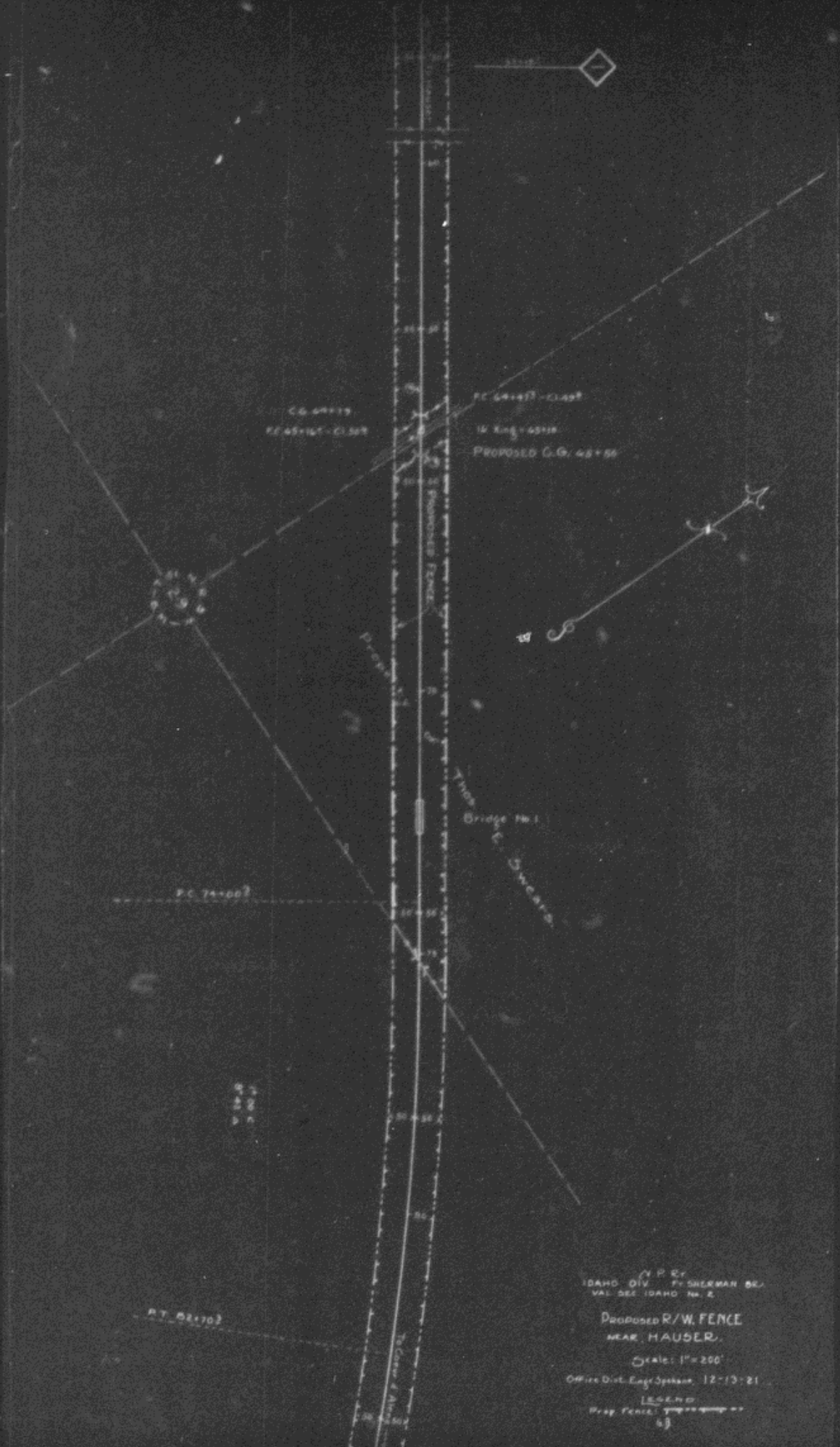

V. P. ST.
 IDAHO DIV. BY SHERMAN BK.
 VAL. SEC. IDAHO No. 2.

**PROPOSED R/W FENCE
 NEAR HAUSER.**

Scale: 1" = 200'

Office Dist. Engr. Spokane, 12-13-21

LEGEND
 Prop. Fence: ————