

1923

COMPTROLLER'S COPY.

Form 1363 SM 6-22 "B"

NORTHERN PACIFIC RAILWAY CO.

AUTHORITY FOR EXPENDITURE

Year: 1923

Superintendent's No. 107
No.

Dept. No. Engineering Dept. No. 125

A. F. E. NO. 32

Minnesota Div. Fergus Falls Branch State Minnesota Val. Sec. No. 13

AUTHORITY IS REQUESTED FOR A NET EXPENDITURE OF \$ 2 169

Accounting distribution as follows: (Distribution to be made in General Office.)

	Operating Expenses	Profit and Loss	Net Operating Expenses	Net Profit and Loss
Cost of property retired	\$ 1 624	\$	\$	\$
Value of salvage	1 225		399	
Incidental costs			769	
Total to Operating Expenses				\$ 1 168
Total to Profit and Loss				1 225
To Material and Supplies				
To Bills for Collection				
To Other Accounts				1 001
Net charge to investment account—Additions and Betterments				\$ 3 394
Total of distribution				

DEPRECIATION DOCUMENT 151.00 ENTERED BY EXHIBIT - C

Original Cost Adjustment Made in 1923 Class of Work: No. 10 3

Budget reference: **Not in Budget**

Joint facility contract reference: **Not Joint Account**

The location is - - - - on this company's property. To secure rights, it will be necessary

Location: **Fergus Falls Branch, Minnesota. (Wadena)**

Title and Reason: **Fergus Falls Branch - Relay Rail.**

In order to get sufficient 66# rail suitable for use in main track repairs, replacing rail rest rail, etc., on the Fergus Falls Branch, the General Superintendent, under date of November 29th, 1922, authorized relaying 2640 track feet of 36# rail with second class 85# rail, from the west wye switch at Wadena Jot. westward 2640 feet on the Fergus Falls Branch; as much of the 66# rail suitable for main track thus made available to be used on the Fergus Falls Branch as needed, balance elsewhere as directed by the Chief Engineer.

Material received and will start relaying today.

Will be completed by December 23rd, 1923.

Work to be done by ~~company force~~ under charge of **Superintendent.**

Checked and Entered President's Office

Handwritten initials and stamp

Accounting to concentrate in the office of **Division Accountant Staples**

Signature and Title: *[Signature]* Superintendent Date **Dec. 15th 1923.**

APPROVED: <i>[Signature]</i> General Superintendent.	<i>[Signature]</i> Engr. Maint. of Way.	<i>[Signature]</i> Assistant General Manager.
<i>[Signature]</i> Mech. Supt., Supt. Tel. or Signal Engr.	<i>[Signature]</i> Chief Engineer.	<i>[Signature]</i> Vice President.
<i>[Signature]</i> For Comptroller.	<i>[Signature]</i> President.	Date of Final Approval } 12 20 23 19

COMPTROLLER'S RECORD OF NOTICE OF APPROVAL AND OF COMPLETION

Form No. 1345 issued **JAN 24 1923** 19 Work begun Work finished **May 29 1923**

Minnesota Div. Fergus Falls Br.
 Proposed Relay of 66" Rail with 85" Rail
 at Wadena, Minn.
 Office of Dist Engr. St. Paul, Minn. Dec. 5, 1922
 Valuation Section No. 14 of Minnesota
 Prop'd Work Shows Red.

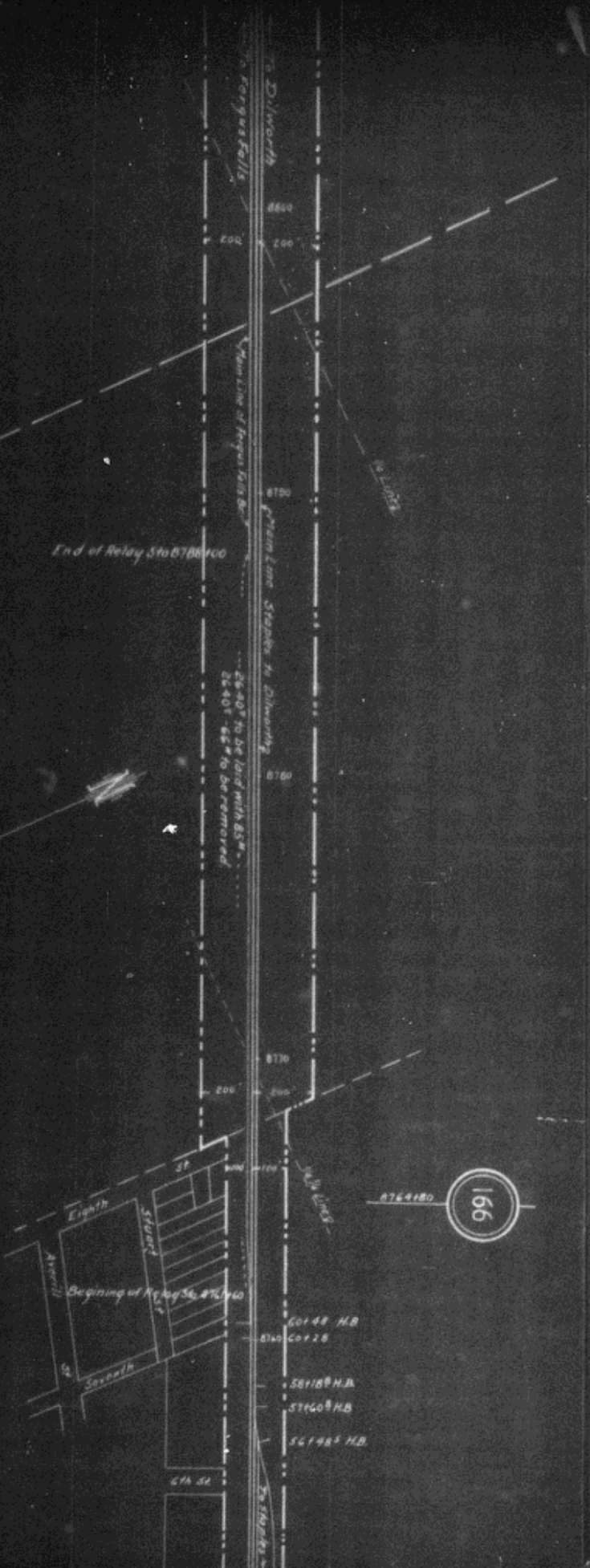

166

6744.80

601.48 H.B.
 601.28
 581.88 H.B.
 576.08 H.B.
 561.95 H.B.

End of Relay Sta 6700.00

26.40' to be laid with 85"
 26.40' to be removed

Beginning of Relay Sta. 6740.00
 Eighth Street
 Seventh Street
 Avenue

