

Department's No. 194 Eng. Dept. No. 11 (1916) Comptroller's No. 72
 In Name of Eugene H. or Operating Dept. State of Oregon Pub. Sec. No. 1

To Equip. Exps. \$ To Advs. and Batts. \$ 377.00 ✓ To

Goble Line
 new work
 old work
 maintenance
 miscellaneous

The location is ¹⁹⁷¹ ~~not on~~ this company's property and is ~~not in~~ ⁱⁿ joint territory. To secure required rights it will be necessary

Contract 24731

*Access to Valuation
 done May 1917
 done 11/16/1917*

At Deer Island on the Northern Pacific tracks between Goble and Portland operated by the Spokane Portland & Seattle Ry Co that company found it necessary to arrange under grade crossing and track connection with tracks of the Columbia County Logging Company. This RFA submitted to cover as per sketch and estimate hereto attached, and covers arrangement as per contract with Columbia County Logging Co. dated Aug. 31, 1915.

N.P. to furnish metal on right of way - Columbia County Logging Company to bear remainder of cost.

RECEIVED
 NOV 30 1916
 WORKS DEPT.
 AND BY ORDER DIS

Work should be commenced completed in order to complete by _____
 and be done by _____ company force _____ under charge of S.P.&S. RY CO

Signature and Title of Applicant: W. D. [unclear] Superintendent Date of Requisition: Nov. 30, 1915

APPROVED BY
 [Signatures] Genl. Supt., Engr. M. of W., Chief Engr. M. of W., Chief Engr., Mech. Supt. or Supt. Telg., General Manager, First Vice President, Second Vice President, Comptroller, President
 Date of Final Approval: Nov 30 1915

COMPTROLLER'S RECORD OF NOTICE OF APPROVAL AND OF COMPLETION

Form 1845 issued 191 Work begun 191 Work finished 191

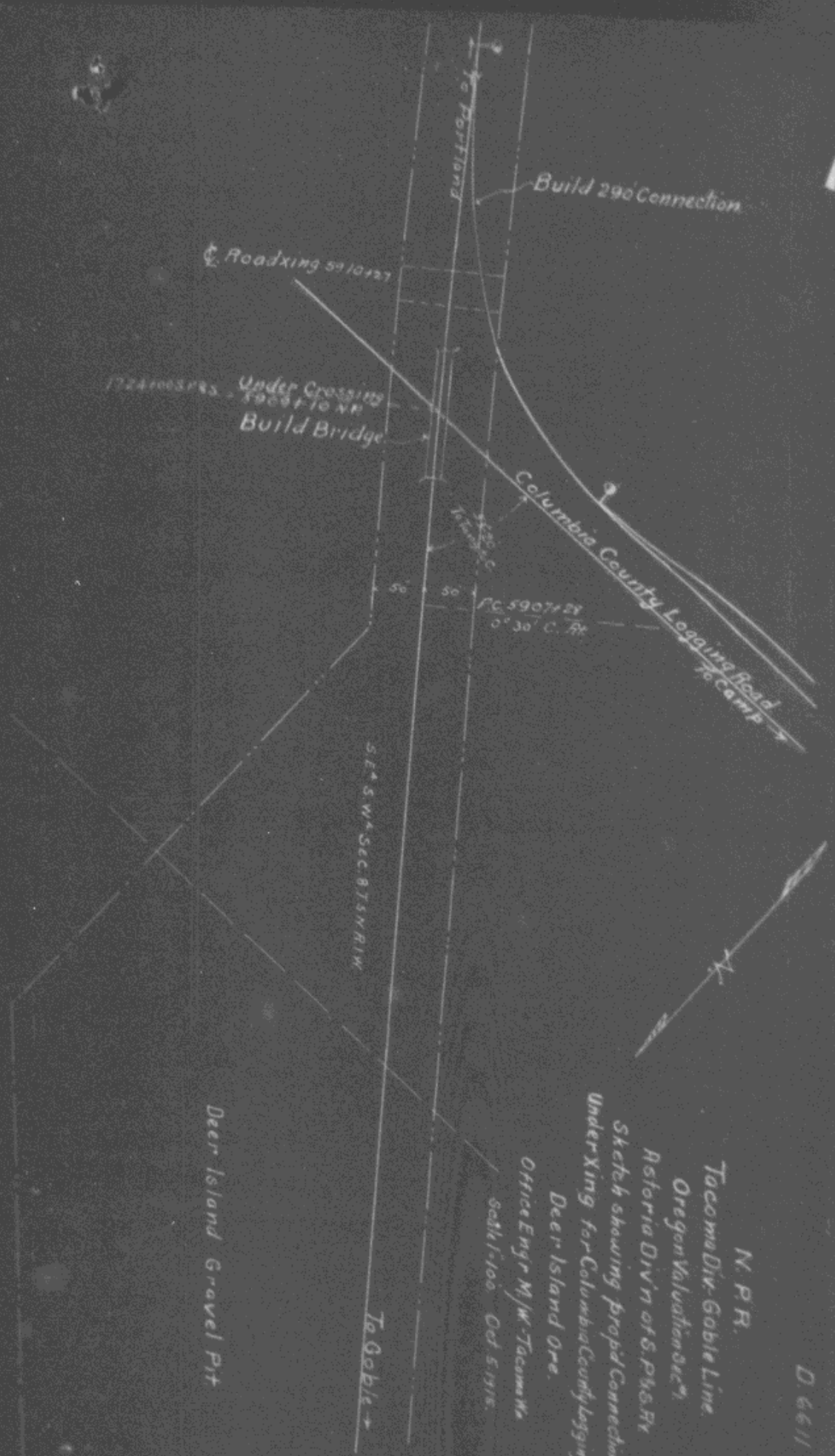

Build 290' Connection

Road Xing 5910127

Under Crossing
50' 10' NR
Build Bridge

Columbia County Logging Road
70' Camp

50' 30' C. Ry

SE 1/4 S.W. 1/4 Sec. 8 T. 5 N. R. 1 W.

Deer Island Gravel Pit

To Goble

N. P. R.
Tacoma Div. Goble Line.
Oregon Valuation Sec. 7
Astoria Div'n of S. P. & Ry.
Sketch showing prop'd Connection and
Under Xing for Columbia County Logging Road

Office Engr M/W - Tacoma Ws
Sohl-100. Oct 5, 1915.

D 6611

14^c 676 15^c 650

Form 1345 1/2

NORTHERN PACIFIC RAILWAY COMPANY.

TACOMA DIVISION

Tacoma, December 20th, 1916

630-10 2M RP
RECEIVED
DEC 20 1916
AUD. DIRS.

Auditor Disbursements

St. Paul, Minn.

Dear Sir:

I beg to advise you that work authorized by A. F. E. Comptrollers' No. 12-16 covering Deer Island- Undergrade crossing and conn. with Columbia County Logging Co. was completed during January, 1916 191 My record is as follows:

	Cost	Appropriation	Difference	Salvage
Material, SP&S Ry ^s	390.42	\$ 373.86	\$ 16.56	\$
Labor,	\$	\$	\$	\$
Engineering,	\$ 4.54	\$ 2.75	\$ 1.79	\$
Contract Work,	\$	\$	\$	\$
Miscellaneous,	\$	\$	\$	\$
		.39	(.39)	
Total	\$ 394.96	\$ 377.00	\$ 17.96	\$

Was your record checked with Form 101?

[Signature]
Superintendent

Charge Bills for Collection Expenses for:

Explanation of Difference and General Remarks:

Work done and material furnished by S.P. & S. Ry. Co. No check made with form 101 in this office.

GJM
File
IBR
AMB
BLC
ECB

JAN 1917

RPA XXXIX 194-13